

ROSCOMMON COUNTY COUNCIL

PLANNING AND DEVELOPMENT ACT, 2000 (as amended)

SECTION 5 - DECLARATION ON DEVELOPMENT AND EXEMPTED DEVELOPMENT

NOTIFICATION OF DECISION

REGISTERED POST

Mr. Peter Gillooly,

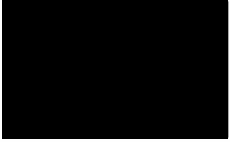

Reference Number: DED 582

Application Received: 26th June, 2023

Location: Roxborough Td., Roscommon, Co. Roscommon.

WHEREAS a question has arisen as to whether works consisting of the construction of a 10kV overhead and underground distribution line between the proposed Derm Wind Farm and the Roscommon 38kV Substation at Roxborough Td., Roscommon, County Roscommon is or is not development or is or is not exempted development.

AND WHEREAS Roscommon County Council, in considering this application, had regard particularly to:

- (a) Sections 2, 3, 4 and 5 of the Planning and Development Act, 2000, as amended**
- (b) Articles 6 and 9 of the Planning and Development Regulations, 2001, as amended**
- (c) Classes 26 and 27 of Part 1 of Schedule 2 of the Planning and Development Regulations, 2001, as amended**
- (d) The record forwarded to Roscommon County Council in accordance with subsection (6)(c) of Section 5 of the Planning and Development Acts 2000 as amended.**
- (e) The planning history of the site**

AND WHEREAS I have concluded that

- The proposed works to construct a 10kV overhead and underground distribution line between the proposed Derm Wind Farm and the Roscommon 38kV substation at Roxborough Townland, Roscommon is development.**
- The proposed development falls within Class 26 and Class 27 of Part 1 of Schedule 2 of the Planning and Development Regulations 2001 as amended and is exempted development.**

NOW THEREFORE:

By virtue of the powers vested in me by the Local Government Acts 1925 – 2019 and Section 5(2)(a) of the Planning and Development Act 2000 (as amended) and having considered the various submissions and reports in connection with the application described above, it is hereby declared that the said works consisting of the construction of a 10kV overhead and underground distribution line between the proposed Derm Wind Farm and the Roscommon 38kV Substation at Roxborough Td., Roscommon, County Roscommon is development that **is exempted development** as defined within the Planning and Development Act 2000 (as amended) and associated Regulations.

Any person issued with a Declaration under Section 5 of the Planning and Development Act, 2000 (as amended) may, on payment to An Bord Pleanála of the prescribed fee, refer a Declaration for review within 4 weeks of the date of the issuing of the Declaration

Signed on behalf of the Council:

Lacey Davis

Senior Executive Planner,
Planning Department.

Date: 19th September, 2023

TLI Group, Unit 1,
Borg Commercial Park,
Monavalley,
Tralee,
Co. Kerry. V92 RC3R

**Planner's Report on application under
Section 5 of the Planning and Development Act 2000 (as amended)**

Reference Number:	DED 582
Re:	Application for a Declaration under Section 5 of the Planning & Development Act, 2000, as amended, regarding Exempted Development for the construction of a 10kV overhead and underground distribution line between the proposed Derm Wind Farm and the Roscommon 38Kv Substation at Roxborough Townland, Roscommon.
Name of Applicant:	Peter Gillooly
Location of Development:	Roxborough, Roscommon.
Recommendation:	Is Exempted Development

Note – This report should be read in conjunction with the previous planner's report on file that requested further information.

Description of Development	Conditions and Limitations
CLASS 26 The carrying out by any undertaker authorised to provide an electricity service of development consisting of the laying underground of mains, pipes, cables or other apparatus for the purposes of the undertaking.	N/A
CLASS 27 The carrying out by any undertaker authorised to provide an electricity service of development consisting of the construction of over-head transmission or distribution lines for conducting electricity at a voltage not exceeding a nominal value of 20kV	N/A

Assessment of information received:

The following further information request was made on 20th July 2023:

1 - Please clarify who the statutory undertaker is in this regard and if they are connected with the proposed operation, that being the provision of electricity.

Response: The applicant has submitted a letter from the Commission for Regulation of Utilities (CRU) stating that Derm Energy Limited (of which Peter Gillooly is a stated Director) can act on their behalf in this manner.

2 – Please provide written confirmation from the said statutory undertaker that the works outlined in this Section 5 application will be carried out by them or on their behalf.

Response: A letter from Derm Energy Limited has been submitted confirming that the works will be carried out by Derm Wind Energy Limited (or on their behalf). Although the response has not been received from the CU directly in this regard as requested, this response is considered acceptable.

Having regard to the above, I am satisfied that the general question raised in this referral can be determined as follows:

- The works are development
- The works to construct a 10Kv overhead and underground distribution line between the proposed Derm Wind Farm and the Roscommon 38Kv substation at Roxborough townland Roscommon falls within Class 26 and Class 27 of Part 1 of Schedule 2 of the Planning and Development Regulations 2001 as amended. There are no conditions/limitations associated with these classes and therefore I have concluded that the proposed development is exempted development.

Recommendation

WHEREAS a question has arisen as to whether a proposed development to construct a 10Kv overhead and underground distribution line between the proposed Derm Wind Farm and the Roscommon 38Kv substation at Roxborough townland Roscommon is or is not development and is or is not exempted development, I have considered this question, and I have had regard particularly to –

- (a) Sections 2, 3, 4 and 5 of the Planning and Development Act, 2000, as amended
- (b) Articles 6 and 9 of the Planning and Development Regulations, 2001, as amended
- (c) Classes 26 and 27 of Part 1 of Schedule 2 of the Planning and Development Regulations, 2001, as amended
- (d) The record forwarded to Roscommon County Council in accordance with subsection (6)(c) of Section 5 of the Planning and Development Acts 2000 as amended.
- (e) The planning history of the site

AND WHEREAS I have concluded that

- The works to construct a 10Kv overhead and underground distribution line between the proposed Derm Wind Farm and the Roscommon 38Kv substation at Roxborough townland Roscommon is development.
- The works falls within Class 26 and Class 27 of Part 1 of Schedule 2 of the Planning and Development Regulations 2001 as amended. There are no conditions/limitations associated with these classes and therefore I have concluded that the proposed development is exempted development.
- The proposed development individually and in combination with other plans or projects would not be likely to have a significant effect on any European site and that the requirement for AA or EIAR does not apply with respect to the current case.

AND WHEREAS I have concluded that the said development to construct a 10Kv overhead and underground distribution line between the proposed Derm Wind Farm and the Roscommon 38Kv substation at Roxborough townland Roscommon is exempted development and I recommend that a declaration to that effect should be issued to the applicant.

Signed 
Executive Planner

Date: 14th September 2023

Caroline Pease

From: Tracy Davis
Sent: Wednesday 30 August 2023 10:16
To: Caroline Pease
Subject: FW: 05-727 : Planning Ref. No. DED/582 - Request for Further Information
Attachments: planning letter.pdf; 15.3.2- 201214 Signed S.I. Approval.pdf; DED 582 FI Request Letter.pdf; DED 582 TLI to Roscommon CoCo.pdf

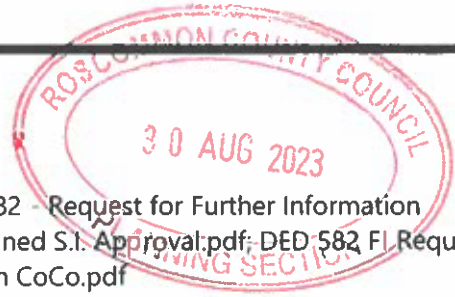

From: Rachael O'Neill <rachael.oneill@tli.ie>
Sent: Tuesday 29 August 2023 14:20
To: Planning Department <Planning@roscommoncoco.ie>
Cc: [REDACTED]
Subject: 05-727 : Planning Ref. No. DED/582 - Request for Further Information

FAO – Mervyn Walsh

Mervyn,

Thank you for your email of July 20th.

Attached, please find our response in relation to the queries that were raised.

We trust this will be sufficient for Roscommon County Council to make a decision, but if you require any further assistance, please let me know.

Can you please confirm this email is sufficient to advance the matter & that a hard copy submission will not be required.

Many thanks

Rachael O' Neill
Graduate Electrical Engineer



TLI Group

Unit 1, Borg Commercial Park, Monavalley, Tralee, Co Kerry V92 RC3R

t: 086 076 1221

e: rachael.oneill@tli.ie

www.tli.ie

Our Values: Safety - Customer - Delivery - Flexibility - People - Teamwork



Please note that I may be sending this email outside your working hours and I do not expect a response or action outside your own working hours

Roscommon County Council
Planning Department
Áras an Chontae
Roscommon
Co. Roscommon
F42 VR98

Our Ref: 05-727

28th August 2023

Your Ref: **DED 582**

Re: Section 5 – Request for Declaration on Development and Exempted Development for the construction of a 10kV Overhead & Underground Distribution Line between the proposed Derm Wind Farm and the Roscommon 38kV Substation

Dear Sirs,

We refer to your Further Information request dated 20th July 2023.

In response, please see the attached documents;

1. Commission for Regulation of Utilities (CRU) document dated 14th December 2020 outlining (i) Authorisation to Construct & (ii) Licence to Generate
2. Letter from Derm Wind Energy Limited signed by our client Mr. Peter Gillooly

We trust the information which has been provided, now confirms CRU authorisation and the associated Statutory Undertaker classification.

It is our opinion that the proposed works comprise of exempted development under the applicable planning and development legislation, and we request that the local authority confirms this opinion formally within a Section 5 Declaration of Exemption.

Thank you for your assistance with this matter.

Yours sincerely,

(For and on behalf of TLI Group)

A handwritten signature in cursive script that reads 'Rachael O'Neill'.

Rachael O'Neill

Derm Wind Energy Limited

Derm Lodge, Derrane, Co. Roscommon, F42 T274.
[REDACTED]

28th August 2023.

Planning Department,
Roscommon County Council,
Aras and Chontae,
Roscommon.

Re: Planning Reference DED 582

Dear Planning Department,

We wish to confirm as Statutory Undertaker (Ref.: Gen 2020/08-01) that the works outlined in the Section 5 Application (Ref.: DED 582) will be carried out by us or on our behalf.

If you have any queries, please do not hesitate to contact us.

For a list of licence holders, please visit : <https://www.cru.ie/regulations-policy/licences/electricity-generation/>

If you have any queries, please do not hesitate to contact us.

Yours Sincerely,

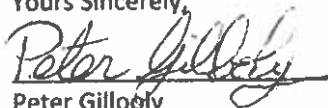

Peter Gillooly
Director



An Coimisiún
um Rialáil Fóntas
Commission for
Regulation of Utilities

The Grain House
The Exchange
Belgard Square North
Tallaght, Dublin 24
D24 PXW0

T +353 1 4000 800
F +353 1 4000 850
E info@cru.ie
www.cru.ie

Letter Ref: D/20/23701

14th December 2020

Mr. Steven Drury
Director
Derm Energy Limited
Greaghcrotta
Tullyco
Cootehill
Co. Cavan

Application ref: Auth/Gen 2020/08-01

**RE: SI Approval – Authorisation to Construct and Licence to Generate for
Roxborough Wind Farm**

Dear Mr. Drury,

I am pleased to inform you that Derm Energy Limited's application to the Commission for Regulation of Utilities (CRU) under Sections 14(1)(a) and 16(3)(a) of the Electricity Regulation Act 1999 for an Authorisation to Construct or Reconstruct a Generating Station and Licence to Generate have been successful. This relates to the 5 MW Wind Farm located at Derrane, Roxborough, Co. Roscommon. The Authorisation and Licence come into effect today, 14th December 2020.

In accordance with the CRU's decision paper of 3rd September 2008 *Revised Process for the Licensing and Authorisation of Generating Stations (CER/08/161)* and the proposals contained therein, by virtue of the 5 MW generating station being under the 10MW threshold as per Statutory Instrument No. 383 of 2008 Electricity Regulation Act 1999 (Section 16(3A)) Order 2008, Derm Energy Limited now stands authorised to construct or reconstruct a generating station by Order. Similarly, in accordance with Statutory Instrument No. 384 of 2008 Electricity Regulation Act 1999 (Section 14(1A)) Order 2008, Derm Energy Limited now stands licensed by Order to generate electricity. A copy of the Orders is attached.

In particular your attention is drawn to Condition 11 & 12 relating to the assignment of a Licence, transfer of the Generation Business and Change in Control of the Licensee. To assist you in the future, compliance guidance notes are also enclosed. Please refer to these to ensure Licence compliance.



An Coimisiún
um Rialáil Fóntas
Commission for
Regulation of Utilities

The terms and conditions of the Authorisation to Construct or Reconstruct a Generating Station and Licence to Generate are set out in the Schedules of the Orders. Your attention is drawn to these conditions.

I would also like to bring to your attention the CRU Decision Paper CER/17/277, which sets out the planned modifications to Generation Licences under the I-SEM project. Such modifications consist of changes to existing Licence conditions as well as the introduction of new Licence conditions.

Please note that in order to trade in the market, in addition to holding the necessary licences from the CRU, accession to the Trading and Settlement Code is required. Applications for market accession are to be made to the Single Electricity Market Operator (SEMO) once the relevant licence from the CRU has been obtained.

To facilitate timely accession to the market, applications should be made as early as possible. Please contact SEMO at registration@sem-o.com for information on this process.

Yours sincerely,



Jim Gannon
Commissioner

Mervyn Walsh

From: Planning Department
Sent: Thursday 20 July 2023 16:54
To: info@tli.ie
Subject: Planning Ref. No. DED/582 - Request for Further Information
Attachments: DED 582 FI Request Letter.pdf

A Chara,

Please find attached, letter dated 20th July, 2023 requesting the submission of Further Information in respect of a declaration under Section 5 of the Planning & Development Act 2000 (as amended), Reference No. DED/582

Given that an e-mail address has not been provided by the applicant, we would be obliged if you could ensure that a copy of this Request for Further Information is provided to the applicant.

Mise le meas

Mervyn Walsh

Mervyn Walsh, Senior Staff Officer,
Planning Department, Roscommon County Council,
Aras an Chontae, Roscommon, Co. Roscommon, F42 VR98
☎: (090) 6637100 Ext. 378 | Direct: (090) 6637378
✉: mwalsh@roscommoncoco.ie | 🌐 www.roscommoncoco.ie

MAP LOCATION





Comhairle Contae
Ros Comáin
Roscommon
County Council



Peter Gillooly,

Date: 20/07/2023
Planning Reference: DED 582

Re: Application for a Declaration under Section 5 of the Planning & Development Act 2000 (as amended), regarding Exempted Development.
Development: The construction of a 10kV overhead and underground distribution line between the proposed Derm Wind Farm and the Roscommon 38kV Substation at Roxborough Td., Roscommon, Co. Roscommon.

A Chara,

Further to your application received on the 26th June, 2023 and in order for the Planning Authority to determine as to whether works a question has arisen as to the construction of a 10kV overhead and underground distribution line between the proposed Derm Wind Farm and the Roscommon 38kV Substation at Roxborough Td., Roscommon, Co. Roscommon is or is not development or is or is not exempted development, you are requested to submit the following further information:

- 1 - Please clarify who the statutory undertaker is in this regard and if they are connected with the proposed operation, that being the provision of electricity.
- 2 – Please provide written confirmation from the said statutory undertaker that the works outlined in this Section 5 application will be carried out by them or on their behalf.

Consideration of your application is being deferred pending compliance with this request for further information. When replying please quote Planning Reference Number **DED 582**.

Note: Replies to this communication must be by way of original documents.

Mise le meas,

Tracy Davis

Senior Executive Planner, Planning.

cc. TLI Group,
Unit 1,
Borg Commercial Park,
Monavalley, Tralee,
Co. Kerry. V92 RC3R

**Planner's Report on application under
Section 5 of the Planning and Development Act 2000 (as amended)**

Reference Number:	DED 582
Re:	Application for a Declaration under Section 5 of the Planning & Development Act, 2000, as amended, regarding Exempted Development for the construction of a 10kV overhead and underground distribution line between the proposed Derm Wind Farm and the Roscommon 38Kv Substation at Roxborough Townland, Roscommon.
Name of Applicant:	Peter Gillooly
Location of Development:	Roxborough, Roscommon.
Recommendation:	Request Further Information

WHEREAS a question has arisen as to whether the following works; the construction of a 10kV overhead and underground distribution line between the proposed Derm Wind Farm and the Roscommon 38Kv Substation at Roxborough Townland, Roscommon **is or is not development and is or is not exempted development.**

I have considered this question, and I have had regard particularly to –

- (a) Sections 2, 3, 4 and 5 of the Planning and Development Act, 2000, as amended
- (b) Articles 6 and 9 of the Planning and Development Regulations, 2001, as amended
- (c) Class 26 Part 1 Schedule 2 of the Planning and Development Regulations, 2001, as amended
- (d) The record forwarded to Roscommon County Council in accordance with subsection (6)(c) of Section 5 of the Planning and Development Acts 2000 as amended.
- (e) The planning history of the site

Site Location & Development Description

The subject site comprises a 5.3km linear route from the proposed Derm windfarm in Derrane, north of Roscommon town, to the Roxborough substation just east of Roscommon town. The proposal involves the erection of 1km of overhead conductor supported on wooden poles structures, and 4.3km of underground cable.

Planning History

PD11/126 – Permission was granted by R.C.C. to Peter Gillooly to erect two number 2.3MW wind turbines, of up to 85 metre hub height and up to 82 metre rotor diameter with a total height not exceeding 126 metres, associated site works to include new internal site tracks, upgrading existing site tracks, turbine hardstands, control sub station, and cabling works.

PD18/313 – Minor amendments granted to same applicant for PD11/126

PD18/447 - Minor amendments granted to same applicant for PD11/126 and PD18/313

PD22/172 – Incomplete application

Relevant statutory provisions

Planning and Development Acts 2000 (as amended)

Section 2. -(1)

“works” includes any act or operation of construction, excavation, demolition, extension, alteration, repair or renewal and, in relation to a protected structure or proposed protected structure, includes any act or operation involving the application or removal of plaster, paint, wallpaper, tiles or other material to or from the surfaces of the interior or exterior of a structure.

Section 2 (1)

“a statutory undertaker” means a person, for the time being, authorized by or under any enactment or instrument under an enactment to –

(b) provide, or carry out works for the provision of gas, electricity or telecommunications services.

Section 3. -(1)

In this Act, “development” means, except where the context otherwise requires, the carrying out of any works on, in, over or under land or the making of any material change in the use of any structures or other land.

Section 4(1) of the Act defines certain types of development as being ‘exempted development’

Section 4 (2) of the Planning and Development Act provides that the Minister, by regulations, provide for any class of development to be exempted development. The principal regulations made under this provision are the Planning and Development Regulations.

Planning and Development Regulations, 2001 as amended

Article 6 (1)

Subject to article 9, development of a class specified in column 1 of Part 1 of Schedule 2 shall be exempted development for the purposes of the Act, provided that such development complies with the conditions and limitations specified in column 2 of the said Part 1 opposite the mention of that class in the said column 1.

Schedule 2, Part 1, Class 26 of the regulations defines the following as exempt development; “the carrying out by any undertaker authorized to provide an electricity service of development consisting of the laying underground of mains, pipes, cables or other apparatus for the purposes of the undertaking”.

Article 9 (1) applies;

Development to which article 6 relates shall not be exempted development for the purposes of the Act

viiB) comprise development in relation to which a planning authority or an Bord Pleanála is the competent authority in relation to appropriate assessment and the development would require an appropriate assessment because it would be likely to have a significant effect on the integrity of a European site,

Planning Assessment:

In order to assess this Section 5 application, clarification is required in order to determine whether the proposed works are being carried out by or on behalf of a statutory undertaker.

Recommendation:

Please request the following further information:

1 - Please clarify who the statutory undertaker is in this regard and if they are connected with the proposed operation, that being the provision of electricity.

2 – Please provide written confirmation from the said statutory undertaker that the works outlined in this Section 5 application will be carried out by them or on their behalf.

Signed _____
Executive Planner

Date: 20th July 2023

Caroline Mockler

From: Planning Department
Sent: Monday 3 July 2023 12:02
To: info@tli.ie
Subject: RCC Planning Ref. No. DED 582 - Acknowledgement of Request for Declaration
Attachments: DED 582 Acknowledgement Letter.pdf; DED 582 Receipt.pdf

A Chara,

Please find attached, letter of acknowledgement in respect of request for a declaration under Section 5 of the Planning & Development Act 2000 (as amended), reference no. DED 582.

Mise le meas,

Caroline Mockler

Caroline Mockler | Senior Staff Officer | Roscommon County Council

☎: (090) 6637100 | ✉: planning@roscommoncoco.ie | www.roscommoncoco.ie

Aras an Chontae, Roscommon, Co. Roscommon. F42 VR98 [MAP LOCATION](#)





Comhairle Contae
Ros Comáin
Roscommon
County Council



Peter Gillooly,

Date: 28th June, 2023.
Planning Reference: DED 582

Re: Application for a Declaration under Section 5 of the Planning & Development Act 2000 (as amended), regarding Exempted Development.
Development: The construction of a 10kV overhead and underground distribution line between the proposed Derm Wind Farm and the Roscommon 38kV Substation at Roxborough Td., Roscommon, Co. Roscommon.

A Chara,

I wish to acknowledge receipt of your application received on the 26th June, 2023, for a Declaration under Section 5 of the Planning & Development Act 2000 (as amended), regarding Exempted Development along with the appropriate fee in the sum of €80.00 Receipt No. **L01/0/223432** dated 27th June, 2023 refers, receipt enclosed herewith.

Note: Please note your Planning Reference No. is **DED 582**.
This should be quoted in all correspondence and telephone queries.

Mise le meas,

Carolín Mounsey

Senior Staff Officer,
Planning.

cc. TLI Group,
Unit 1,
Borg Commercial Park,
Monavalley, Tralee,
Co. Kerry. V92 RC3R

Roscommon County Council
Aras an Chontae
Roscommon
09066 37100

27/08/2023 11:57:20

Receipt No. : L01/0/223432

[REDACTED]
C/O TLI GROUP
UNIT 1, BORG COMMERCIAL PARK
MONAVALLEY
TRALEE, CO. KERRY

EXEMPTED DEVELOPMENT

PLANNING APPLICATION FEES	80.00
GOODS	80.00
VAT Exempt/Non-vatable	
DED 582	

Total :	80.00 EUR
---------	-----------

Tendered :	
Cheque	80.00
500007	

Change :	0.00
----------	------

Issued By : Louis Carroll
From : Central Cash Office



Comhairle Contae
Ros Comáin
Roscommon
County Council



Áras an Chontae,
Roscommon,
Co. Roscommon.

Phone: (090) 6637100

Email: planning@roscommoncoco.ie

Roscommon County Council

Application for a Declaration under Section 5 of the Planning & Development Act 2000, regarding Exempted Development

Name:	Peter Gillooly.
Address:	
Name & Address of Agent:	TLI Group Unit 1, Borg Commercial Park, Monavalley, Tralee, Co Kerry V92 RC3R
Nature of Proposed Works	Derm Wind Farm 10kV Grid Connection. The proposed route is 5km approximately and runs in a northerly direction from Roscommon 38kV Substation
Location (Townland & O.S No.)	Roxborough. O.S Map Ref Number : 35:16
Floor Area	N/A
Height above ground level	N/A
Total area of private open space remaining after completion of this development	N/A
Roofing Material (Slates, Tiles, other) (Specify)	N/A
Proposed external walling (plaster, stonework, brick or other finish, giving colour)	N/A
Is proposed works located at front/rear/side of existing house.	N/A



Roscommon County Council

Application for a Declaration under Section 5 of the Planning & Development Act 2000,
regarding Exempted Development

Has an application been made previously for this site	No
If yes give ref. number (include full details of existing extension, if any)	
Existing use of land or structure	Agricultural Use.
Proposed use of land or structure	10kV underground cable and Overhead Line to facilitate the connection of Derm Wind Farm to existing Roscommon 38kV Substation.
Distance of proposed building line from edge of roadway	N/A
Does the proposed development involve the provision of a piped water supply	N/A
Does the proposed development involve the provision of sanitary facilities	N/A

Signature:

Richard O'Neill

Date:

21.06.23

Note: This application must be accompanied by:-

- (a) €80 fee
- (b) Site Location map to a scale of 1:2500 clearly identifying the location
- (c) Site Layout plan to the scale of 1:500 indicating exact location of proposed development
- (d) Detailed specification of development proposed



Planning Department
Áras an Chontae
Roscommon
Co. Roscommon

Our Ref: 05-727

21TH June 2023

Re: Section 5 – Request for Declaration on Development and Exempted Development for the construction of a 10kV Overhead & Underground Distribution Line between the proposed Derm Wind Farm and the Roscommon 38kV Substation

Dear Sir/Madam,

We, TLI Group on behalf of our client Peter Gillooly, are making this submission to seek a declaration in accordance with Section 5 of the Planning and Development Act, 2000 that the proposed Derm Wind Farm 10kV Grid Connection constitutes "exempted development".

The question as we have phrased it the enclosed application form is ***"Whether or not the construction of a 10kV underground cable (4.3km approx.) & a 10kV overhead line (1.01km approx.) from the proposed Derm Wind Farm, Derrane, Co. Roscommon being the proposed grid connection to the existing Roscommon 38kV substation at Lanesborough Road, Co. Roscommon, is development and if so is or is not exempted development."***

BACKGROUND INFORMATION

The project involves installation of an underground cable and overhead line to facilitate the connection of Derm Wind Farm (Planning Ref.11126) to the Irish Transmission/Distribution System at the Roscommon 38kV Substation.

The proposed grid connection will consist of approximately 1km of overhead conductor supported on wooden pole structures. In addition, there will be approximately 4.3km of 10kV underground cable. It will be necessary to cross one bridge structure this will be achieved by horizontal directional drilling (HDD) under the Creevyquin stream.

INFORMATION SUBMITTED

In support of this Section 5 application we now forward the following information;

1. APPLICANT NAME

Peter Gillooly

2. AGENT & ADDRESS FOR ALL RELEVANT CORRESPONDENCE

TLI Group, Unit 1, Borg Commercial Park, Monavalley, Tralee, Co. Kerry
V92 RC3R

3. CONTACT

Rachael O'Neill

TELEPHONE

086 -0761221

4. RELEVANT FEE

€80 enclosed

Appendix 1: Drawings indicating the extent of the proposed grid connection works

GROUND'S FOR EXEMPTED DEVELOPMENT STATUS

It is our opinion that under the Planning and Development Regulations 2001-2023 (as amended) the works as proposed is exempted development under the applicable legislation. We therefore request that the local authority confirms this opinion formally within a Section 5 Declaration of Exemption.

We trust we have supplied all necessary information to allow you consider this application. If, during your consideration of the application, you should require any further assistance or information please let us know.

Yours sincerely,

(For and on behalf of TLI Group)

Rachael O'Neill

Project Title	Derm Wind Farm
----------------------	----------------

Project No.	05-727
--------------------	--------

Title	Drawing/ Doc Number	Size	Revision									
Site Location Map	05727-DR-100	A1		P1								
Overall Site Layout	05727-DR-100A	A1		P1								
Overall Site Layout	05727-DR-100B	A1	F01	P1								
Overall Site Layout	05727-DR-100C	A1	F01	P1								
Typical structures- EP	05-727-DR-201	A3	-	P1								
Typical structures- IMP	05-727-DR-202	A3	-	P1								
Typical structures- Medium & Heavy	05-727-DR-203	A3	-	P1								
Joint Bay Details	05727-DR-301	A3	-	P1								
Typical Communications Chamber	05727-DR-302	A3		P1								
Ducting through National Road	05727-DR-303	A3	-	P1								
Typical Transition Chamber Detail	05727-DR-304	A3	-	P1								
Typical 10kV Ducting through	05727-DR-305	A3	-	P1								
Ducting through Local Road SD7	05727-DR-306	A3	-	P1								
Ducting Through local road SD4	05727-DR-307	A3	-	P1								
Detail HDD Design	05727-DR-308	A3	-	P1								

Issue Date	D	08	21									
	M	11	06									
	Y	22	23									

Distribution List

Roscommon County Council	1	1										

Status:

P = Preliminary, A = Approval, T = Tender, C = Construction, R = Record, I = Information, PL = Planning

Status	I	PL										
---------------	---	----	--	--	--	--	--	--	--	--	--	--

Method

Method	E	PL										
---------------	---	----	--	--	--	--	--	--	--	--	--	--

Issue Method:

C = CD, E = Email, P = Paper



Designed by Rachael O'Neill

Approved by Alistair Clarke

Issued by Jack Foley

For & on behalf of TLI Group

Map Series:
Discovery Raster Tiles ITM OS1826_D

Ordnance Survey Ireland Licence No.
CYAL50261649

Copyright:
© Suirbhéireacht Ordnáis Éireann, 2023
© Ordnance Survey Ireland, 2023

Project Management Initials Designer: RON Checked: JF Approved: AC ISO A3 297mm x 420mm

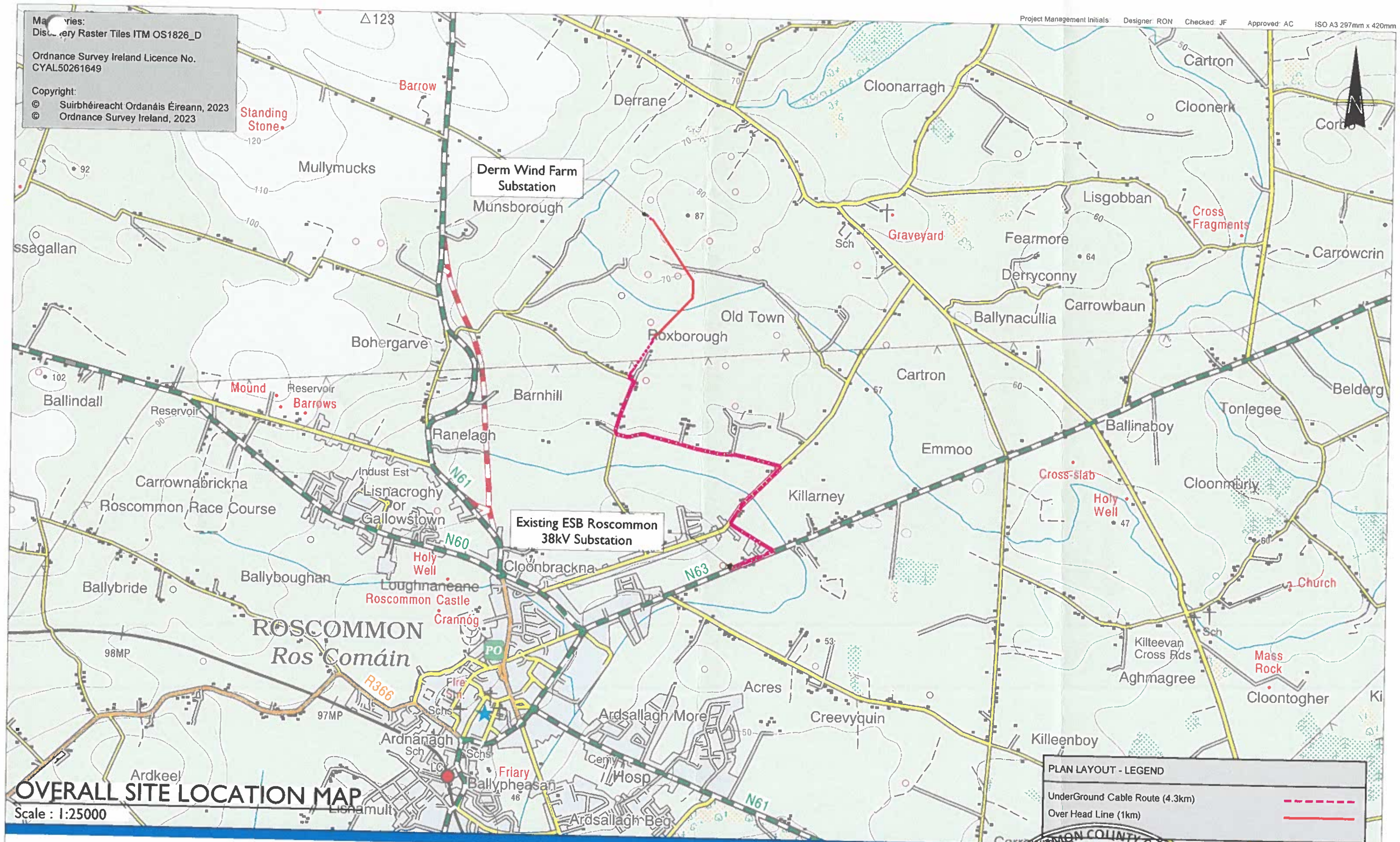

OVERALL SITE LOCATION MAP

Scale : 1:25000



Head Office
Beenreigh,
Abbeydorney,
Tralee, Co. Kerry
Ireland
Tel: 00353 66 7135710

CLIENT
Peter Gillyooly

PROJECT
**Derm Wind Farm
10kV Grid Connection**

PROJECT NUMBER
05-727

SHEET NUMBER
05727-DR-100

SHEET TITLE
**Overall Site Location Map
Discovery Map Series**

DRAWING STATUS
Section 5

PLAN LAYOUT - LEGEND

UnderGround Cable Route (4.3km)
Over Head Line (1km)

ISSUE/REVISION
2 6 JUN 2023

PLANNING SECTION
I/R DATE

Issued for Section 5
DESCRIPTION

- NOTES:-
- This drawing is to be read in conjunction with relevant engineering drawings, specifications and reports
 - Dimensions are in millimeters, unless noted otherwise
 - Drawings are not to be scaled use figured dimensions only

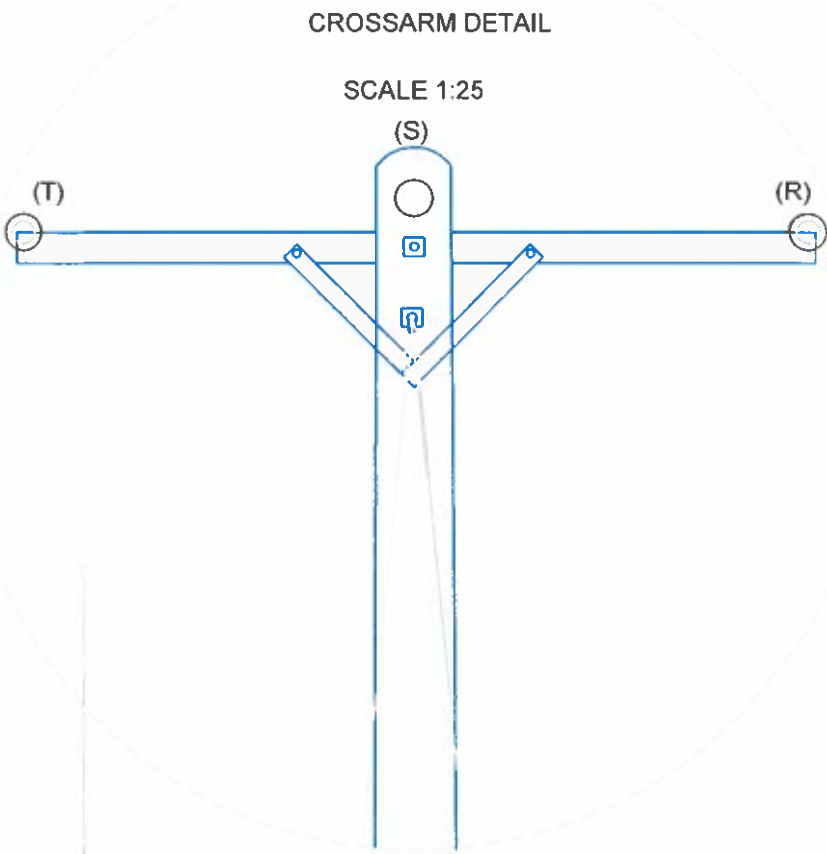
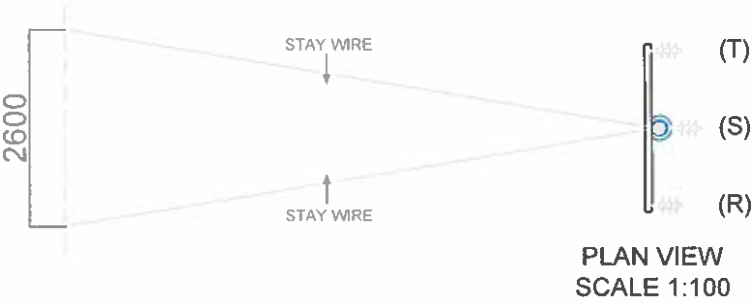
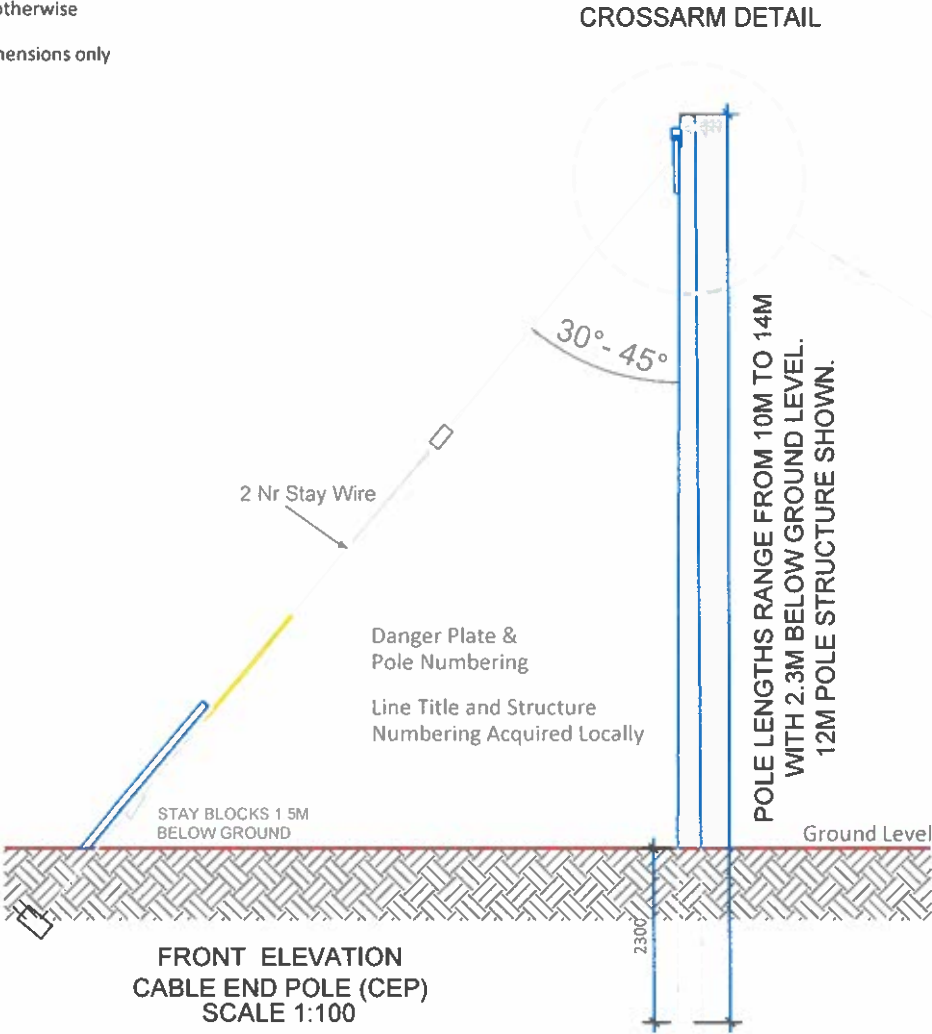

ISSUED FOR SECTION 5.
NOT FOR CONSTRUCTION



Head Office
Beenreigh,
Abbeydorney,
Tralee, Co. Kerry
Ireland
Tel: 00353 66 7135710

CLIENT
Peter Gillooly

PROJECT
Derm Wind Farm
10kV Grid Connection

PROJECT NUMBER
05-727

SHEET NUMBER
05727-DR-201

SHEET TITLE
Typical Structures -
Cable End Pole (EP)

DRAWING STATUS
For Section 5

ISSUE/REVISION		
P1	21.06.23	Issued for Section 5
I/R	DATE	DESCRIPTION

- Notes:-
- This drawing is to be read in conjunction with relevant engineering drawings, specifications and reports
 - Dimensions are in millimeters, unless noted otherwise
 - Drawings are not to be scaled use figured dimensions only

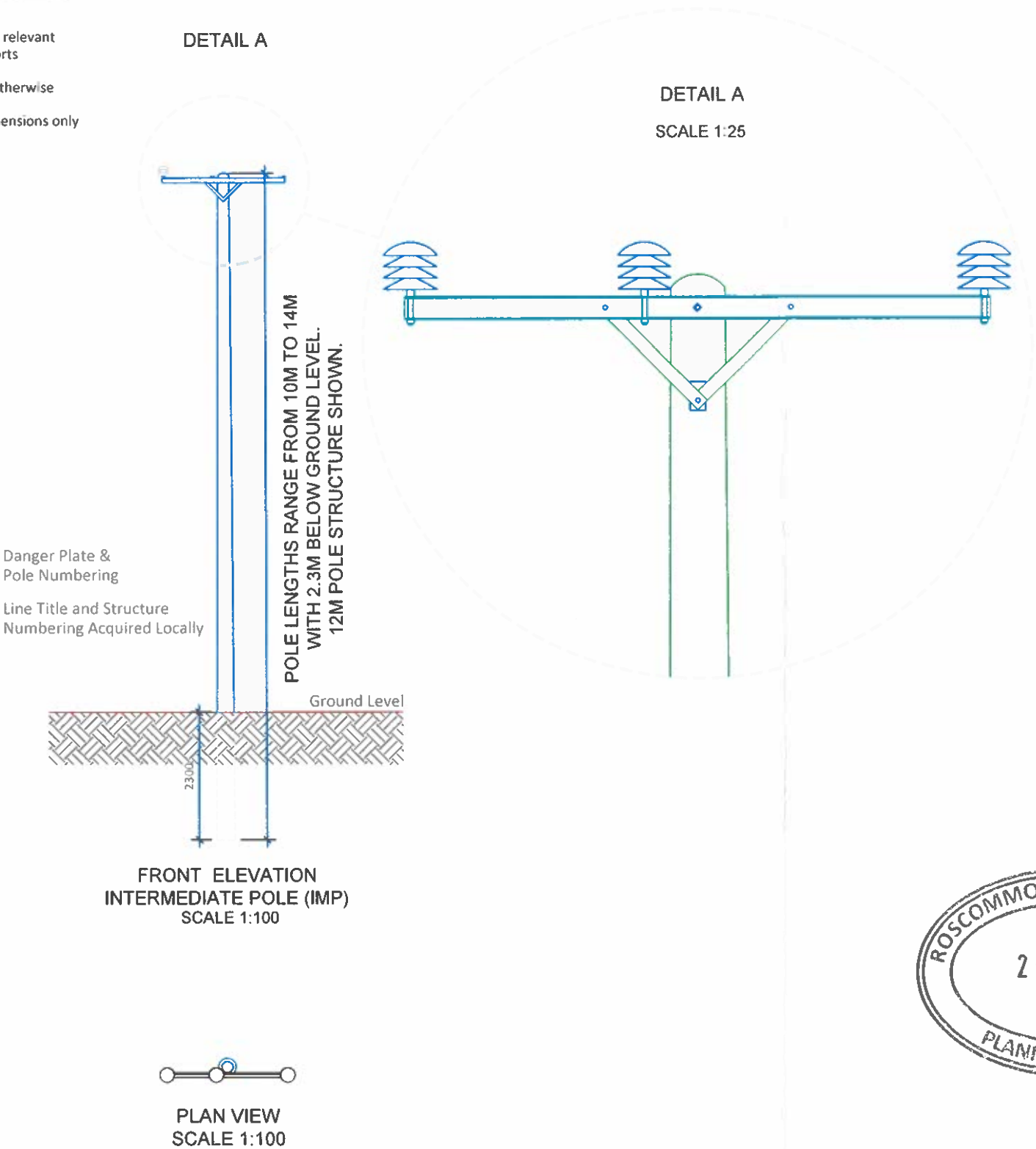

VIEW OF INTERMEDIATE POLE HEAD

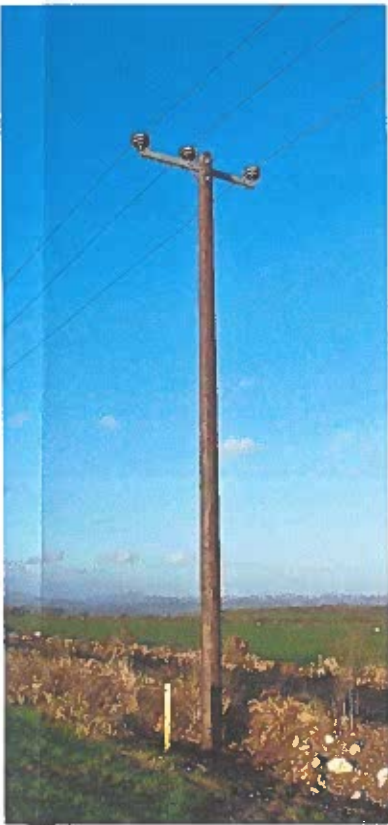

VIEW OF INTERMEDIATE POLE (IMP)



ISSUED FOR SECTION 5.
NOT FOR CONSTRUCTION



Head Office
Beenreigh,
Abbeydorney,
Tralee, Co. Kerry
Ireland
Tel: 00353 66 7135710

CLIENT
Peter Gillooly

PROJECT
Derm Wind Farm
10kV Grid Connection

PROJECT NUMBER
05-727

SHEET NUMBER
05727-DR-202

SHEET TITLE
Typical Structures -
Intermediate Pole (IMP)

DRAWING STATUS
For Section 5

ISSUE/REVISION		
P1	21.06.23	Issued for Section 5
I/R	DATE	DESCRIPTION

- N** :-
- This drawing is to be read in conjunction with relevant engineering drawings, specifications and reports
 - Dimensions are in millimeters, unless noted otherwise
 - Drawings are not to be scaled use figured dimensions only

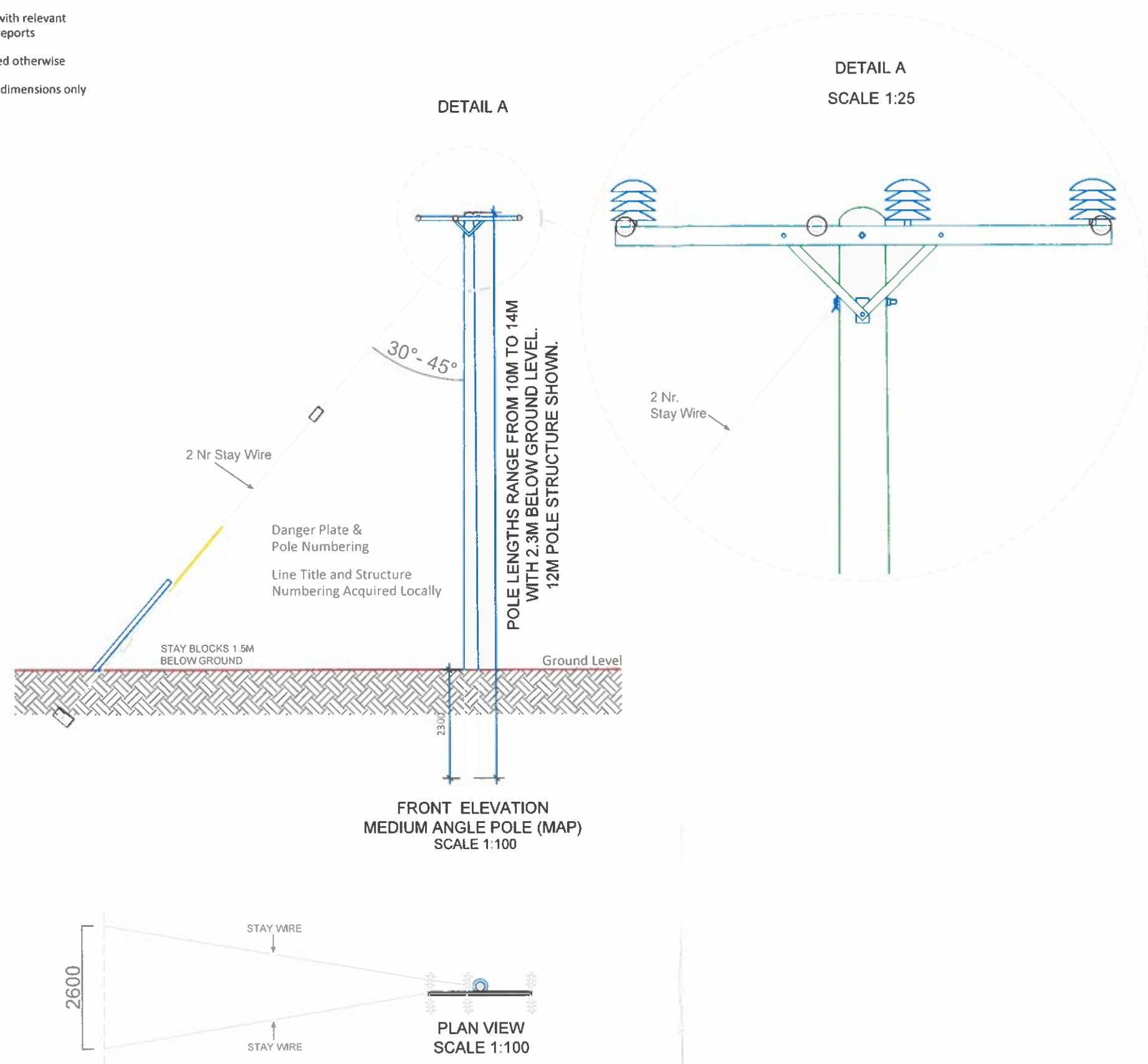

ISSUED FOR SECTION 5.
NOT FOR CONSTRUCTION



Head Office
Beenreigh,
Abbeydorney,
Tralee, Co. Kerry
Ireland
Tel: 00353 66 7135710

CLIENT
Peter Gillooly

PROJECT
Derm Wind Farm
10kV Grid Connection
PROJECT NUMBER
05-727

SHEET NUMBER
05727-DR-203

SHEET TITLE
Typical Structures - Medium &
Heavy Angle Pole (MAP&HAP)
DRAWING STATUS
For Section 5

ISSUE/REVISION		
P1	21.06.23	Issued for Section 5
I/R	DATE	DESCRIPTION

Typical Precast Concrete Joint Bay Details

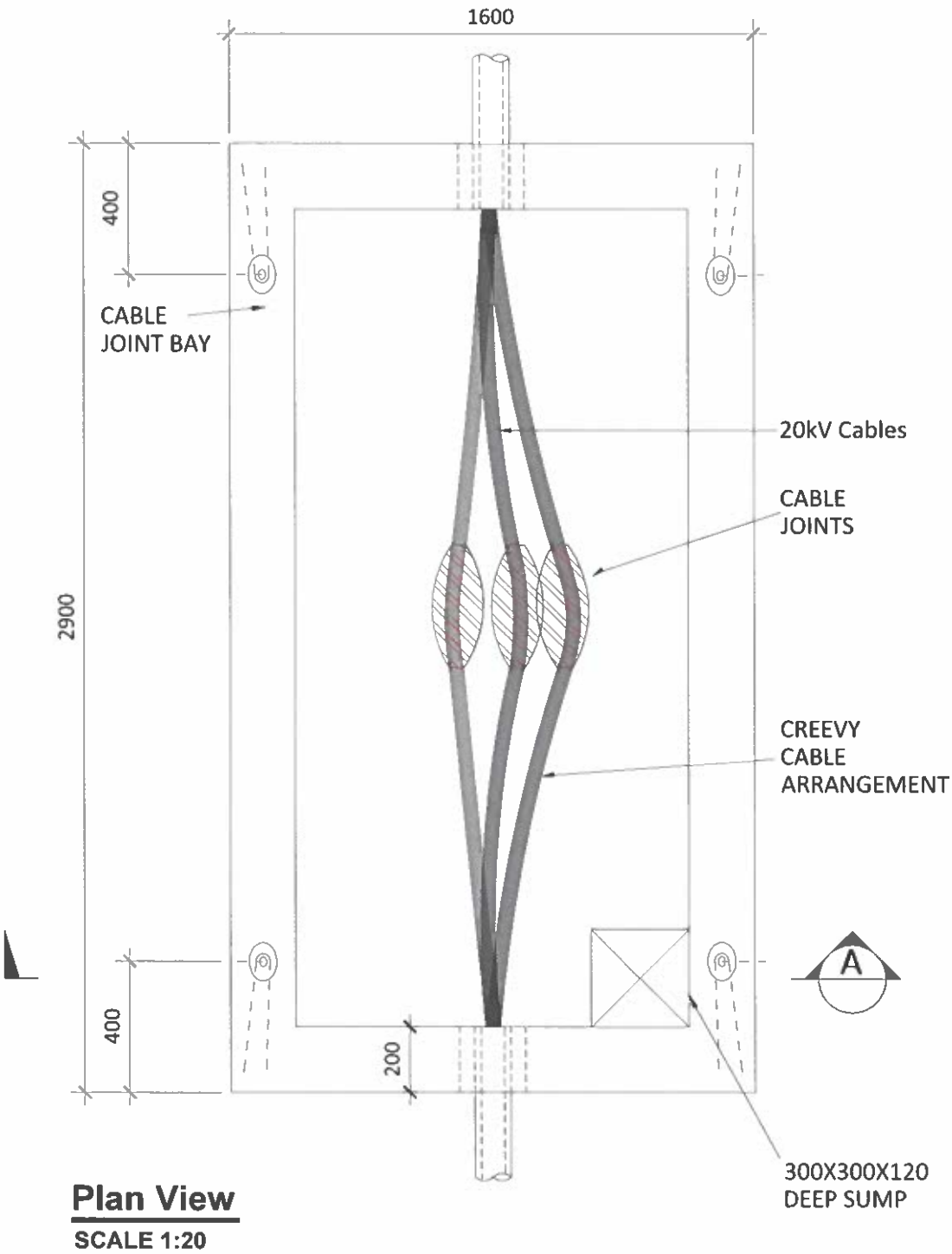

- NOTES:
- This drawing is to be read in conjunction with relevant drawings, specifications and reports
 - Dimensions are in millimetres, unless noted otherwise
 - Drawings are not to be scaled use figured dimensions only
 - Precast Joint Bay Supplier to be approved by ESBN

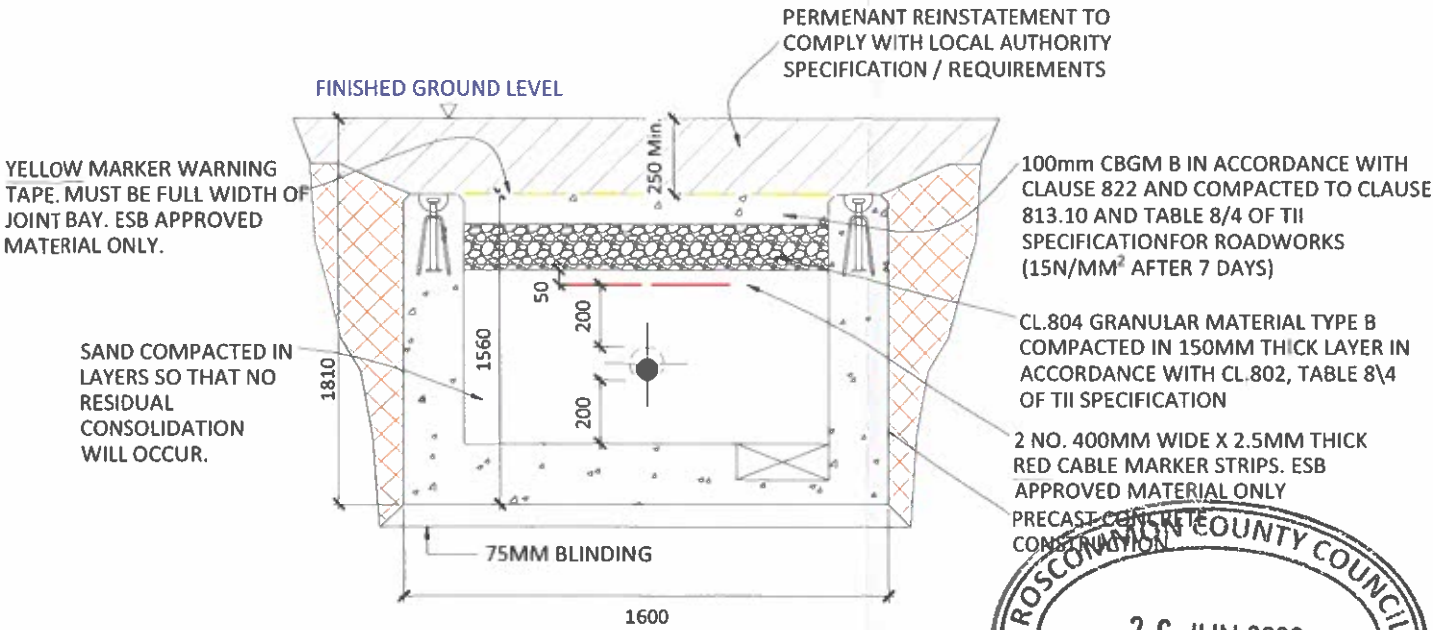

Section A-A Permanent Reinstatement

SCALE 1:50

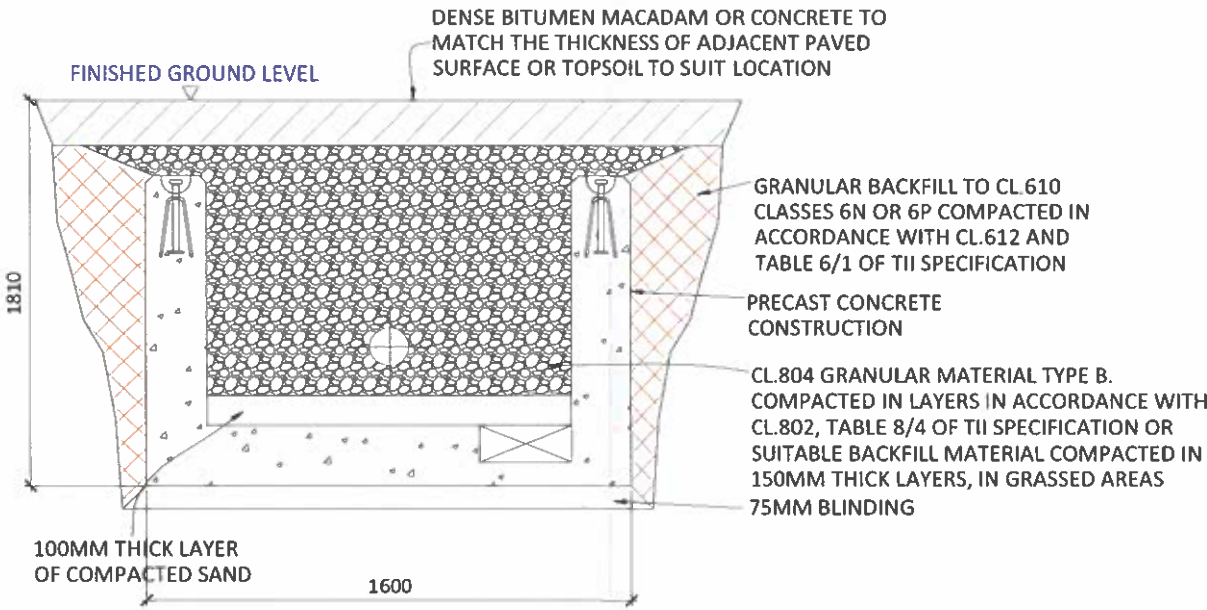

Section A-A Temporary Reinstatement

SCALE 1:50

ISSUED FOR SECTION 5.
NOT FOR CONSTRUCTION

ISSUE/REVISION		
P1	21.06.23	Issued for Section 5
I/R	DATE	DESCRIPTION

- NOTES:**
- This drawing is to be read in conjunction with relevant drawings, specifications and reports.
 - Dimensions are in millimetres, unless noted otherwise.
 - Drawings are not to be scaled use figured dimensions only.

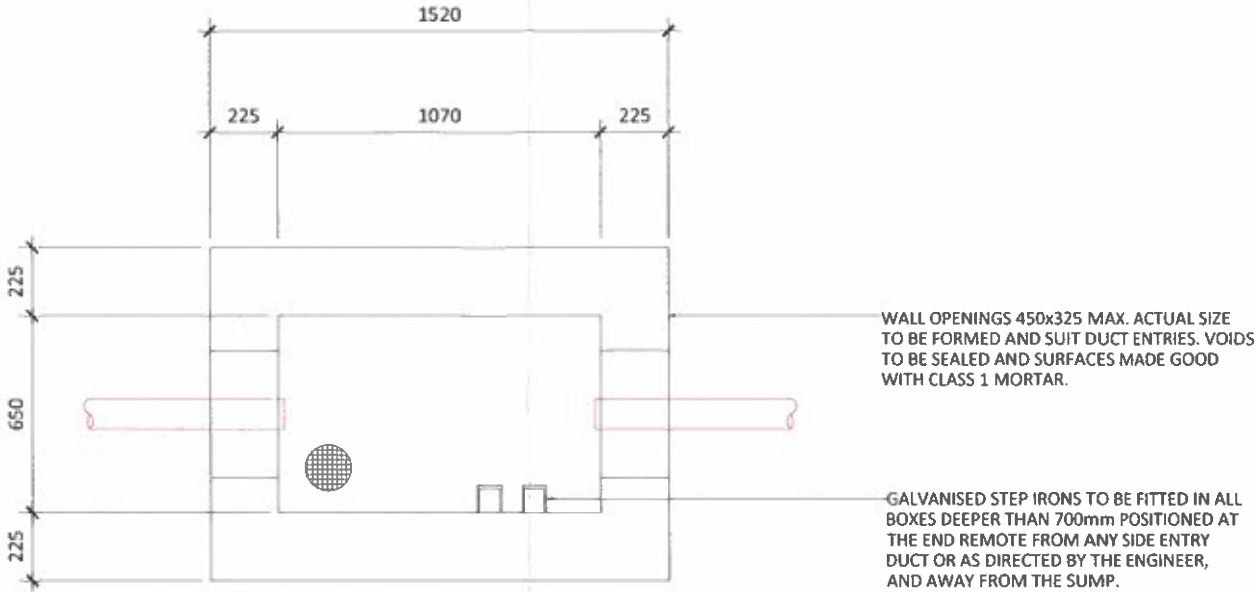

Plan View - Typical Communications Chamber
SCALE 1:20

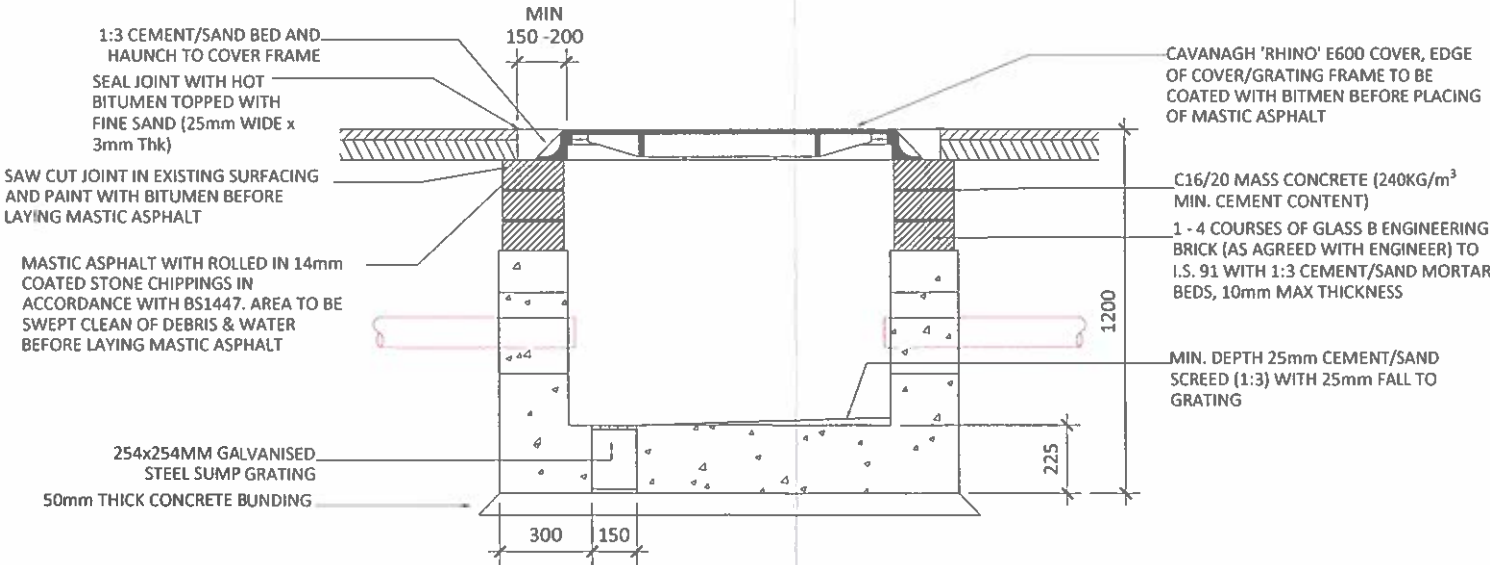

Section Through Typical Communications Chamber
SCALE 1:20

ISSUED FOR SECTION 5.
NOT FOR CONSTRUCTION



Head Office
Beenreigh,
Abbeydorney,
Tralee, Co. Kerry
Ireland
Tel: 00353 66 7135710

CLIENT
Peter Gillooly

PROJECT
Derm Wind Farm
10kV Grid Connection

PROJECT NUMBER
05-727

SHEET NUMBER
05727-DR-302

SHEET TITLE
Typical Communications
Chamber Details

DRAWING STATUS
Section 5

ISSUE/REVISION		
P1	21.06.23	Issued for Section 5
I/R	DATE	DESCRIPTION

SCALE 1:10

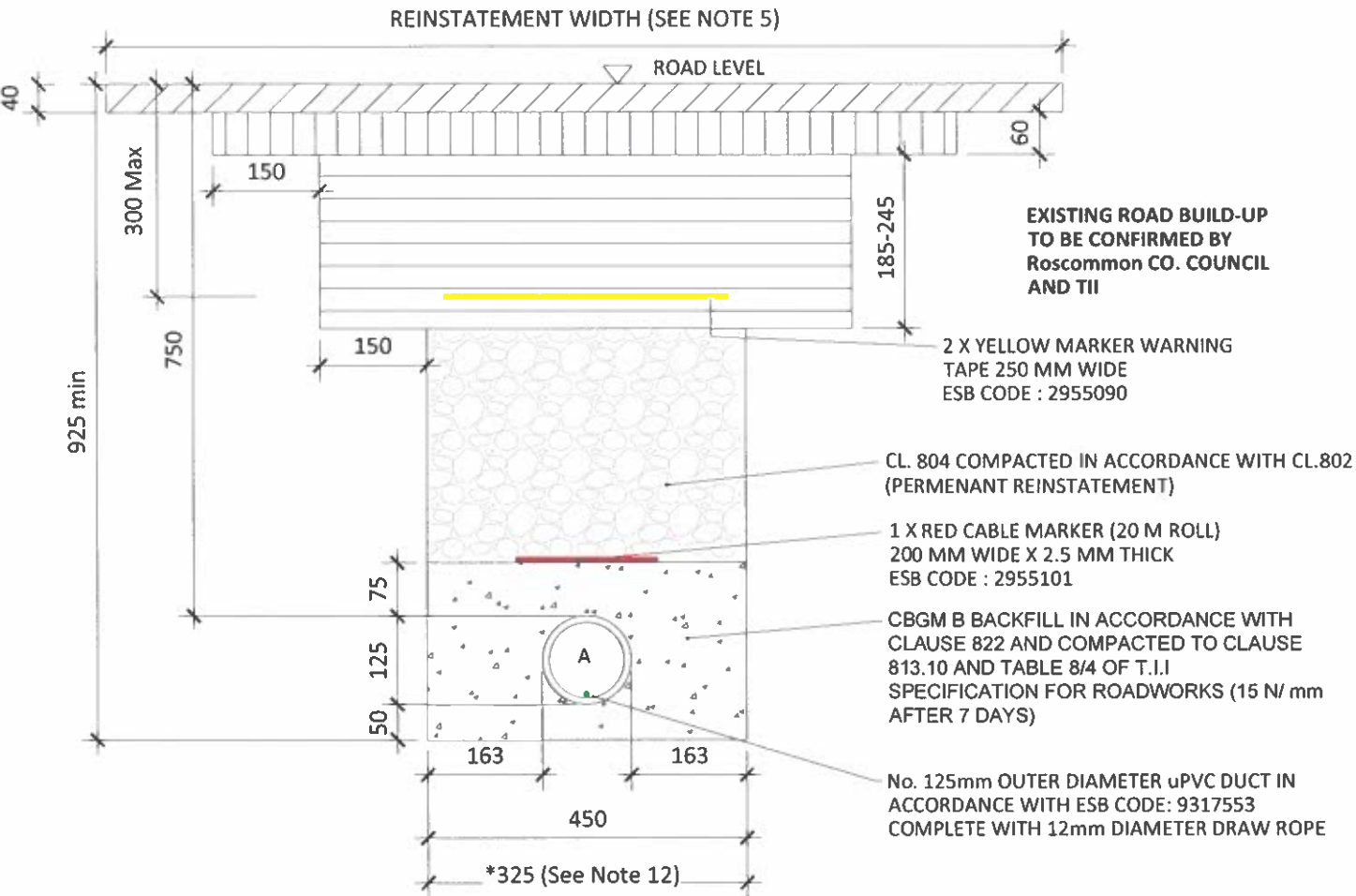

All Permanent Reinstatement (Flexible Road)

SCALE 1:10

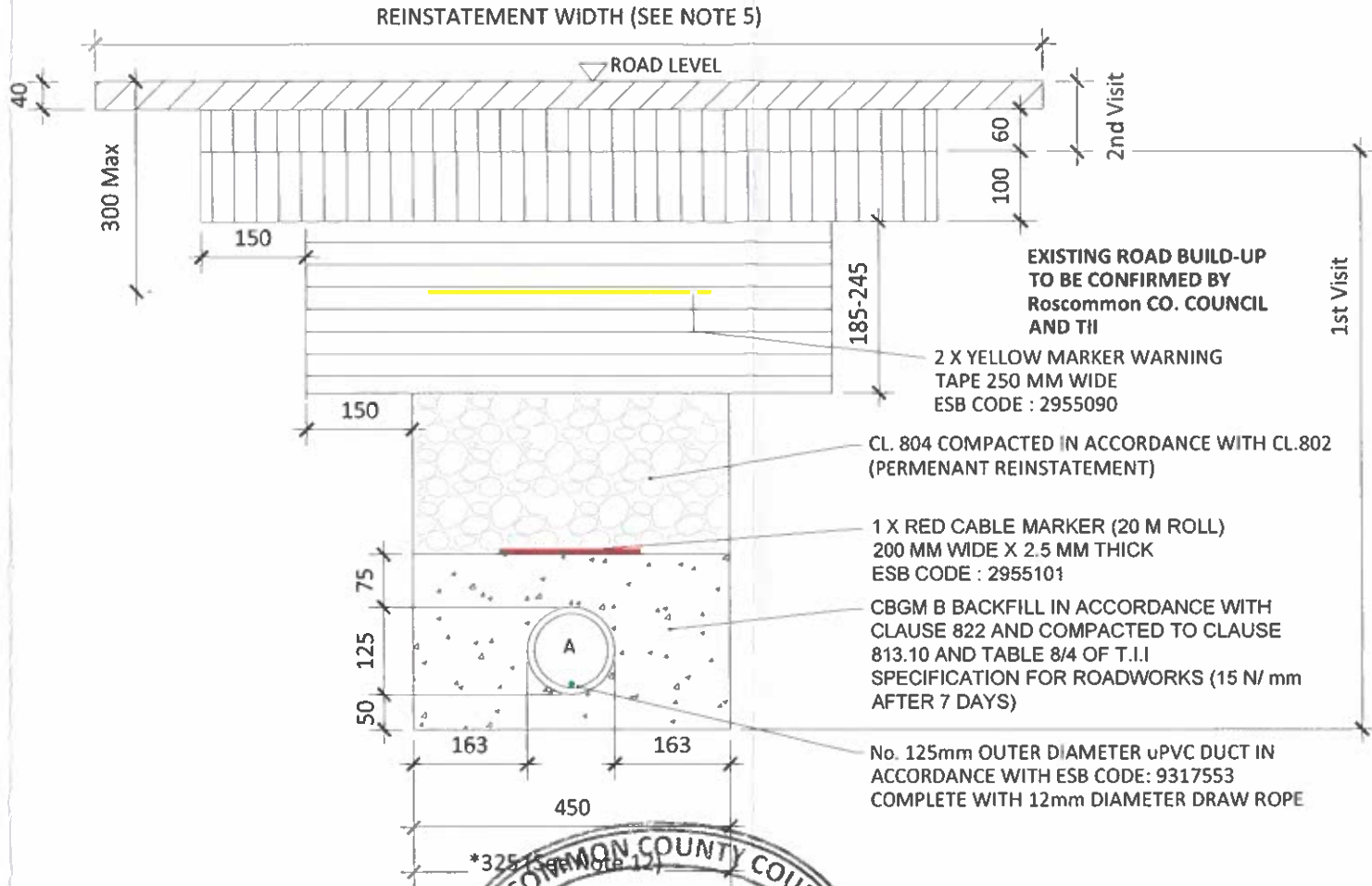

Permanent Binder Course Reinstatement (Flexible Road)

NOTES:

Ref. Specification for the reinstatement of openings in National Roads CC-SPW04007

- Sub-base in accordance with appendix A3.3
- AC surface course not permitted on high speed roads (refer to A2.3).
- Where 10mm PMSMA is used on the surface course the thickness is reduced to 30mm and the binder course increased accordingly.
- Refer to figure S6.4 for further details on surface course reinstatement and stepped joints at binder course level
- Refer to figure A3.4 of this appendix for details on reinstatement requirements at locations where existing surface course material is greater than 5 years old.
- For alternative reinstatement materials refer to appendix A9

- This drawing is to be read in conjunction with relevant drawings, specifications and reports.
- This design is subject to ESB approval and should be used for information purposes only.
- Dimensions are in millimeters, unless noted otherwise. Drawings are not to be scaled use figured dimensions only.
- Existing road build up and reinstatement requirements to be confirmed with Roscommon Co.Co. / TII
- Where required by the Road authority the trench may be reinstated with a Cement Bound Granular Material.
- 325 mm trench width is also acceptable to ESN provided trench compaction measures are in accordance with the DDTAS Purple Book Section 6.3.5 requirements (guidelines for managing openings in public roads) or TII specification CC-PAV 04-007 (2019) guidelines for reinstatement of openings in National roads, as appropriate.

	HRASC (Hot Rolled Asphalt Surface Course)
	ACSC (Asphalt Concrete Surface Course)-See note 2
	PMSMA (Polymer Modified Stone Mastic Asphalt)-See note 3
	AC BIN (Asphalt Concrete Binder Course)
	AC BASE (Asphalt Concrete Base Course)



Head Office
Beenreigh,
Abbeydorney,
Tralee, Co. Kerry
Ireland
Tel: 00353 66 7135710

APPLICANT
Peter Gillooly

PROJECT
Derm Wind Farm
10kV Grid Connection

PROJECT NUMBER
05-727

SHEET NUMBER
05727-DR-303

SHEET TITLE
Ducting Through National Road

DRAWING STATUS
Section 5

ISSUE/REVISION

I/R	DATE	DESCRIPTION
P1	21.06.23	Issued for Section 5

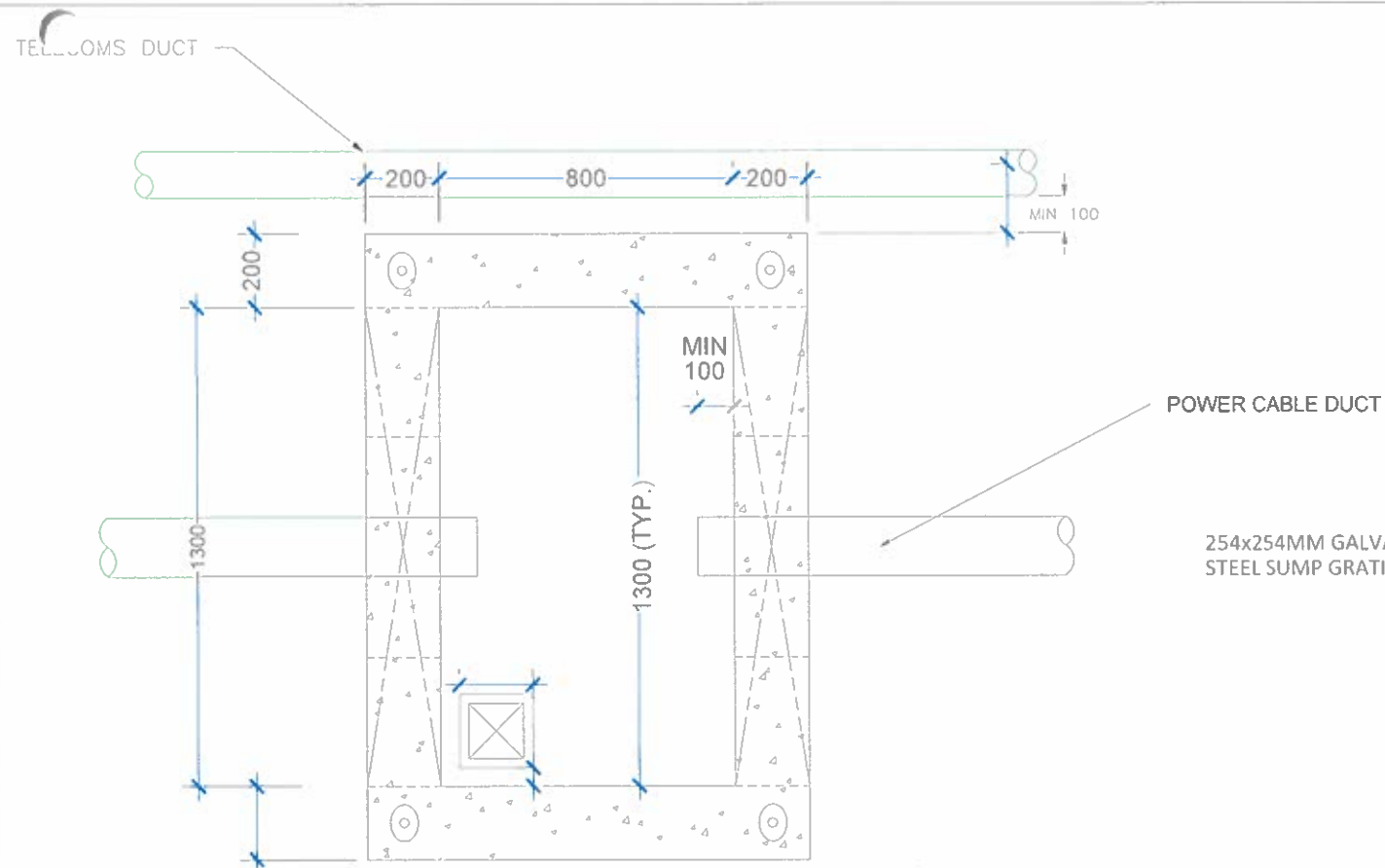

Plan - Transition Chamber
SCALE 1:20

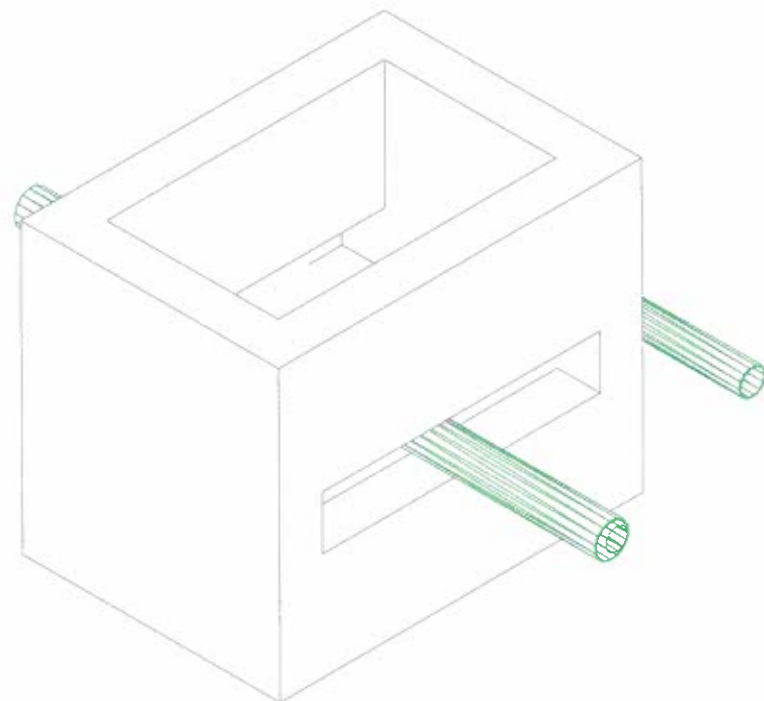

Section A
SCALE 1:20

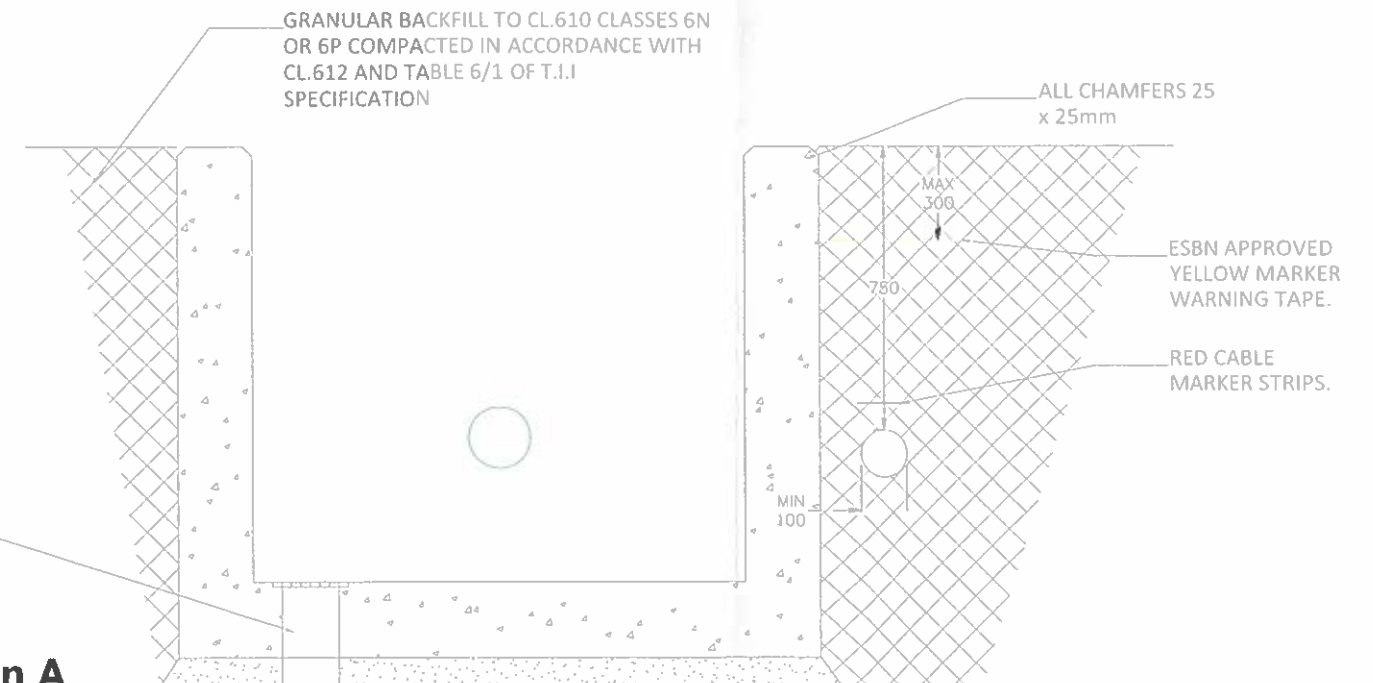

NOTES:

1. This drawing is to be read in conjunction with relevant drawings, specifications and reports.
2. Dimensions are in millimetres, unless noted otherwise.
3. Drawings are not to be scaled use figured dimensions only.
4. Telecommunication ducts not to be routed through Transition chamber
5. If Transition chamber is used to interface with a HDD section, Then the telecoms duct SDR 17.6 should be chamfered when coupled with SDR 11 ducts

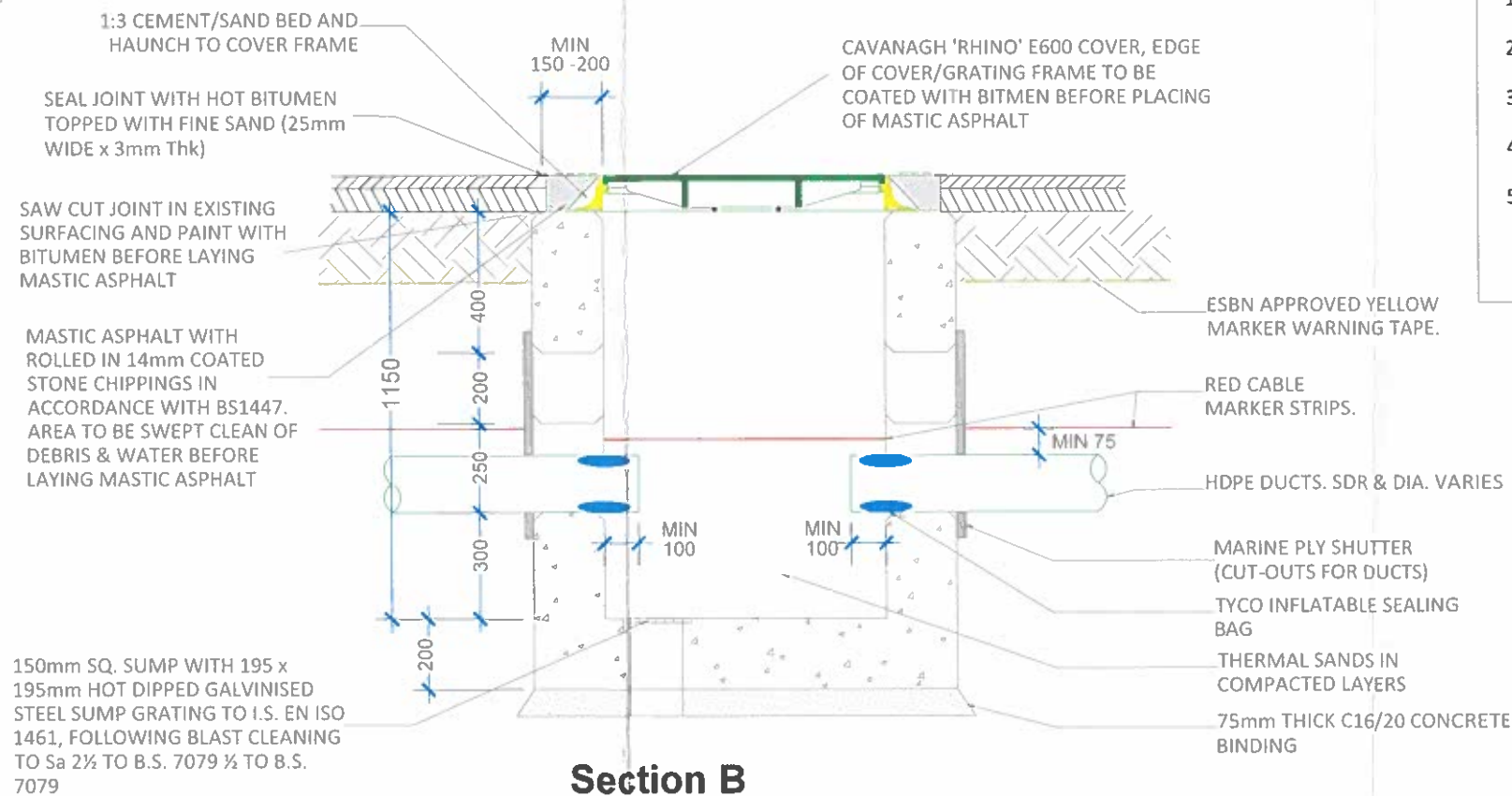

Section B
SCALE 1:20



ISSUED FOR SECTION 5.
NOT FOR CONSTRUCTION



Head Office
Beenreigh,
Abbeydorney,
Tralee, Co. Kerry
Ireland
Tel: 00353 66 7135710

CLIENT
Peter Gillooly

PROJECT
**Derm Wind Farm
10kV Grid Connection**

PROJECT NUMBER
05-727

SHEET NUMBER
05727-DR-304

SHEET TITLE
**Typical Transition Chamber
Details**

DRAWING STATUS
Issued for Section 5

ISSUE/REVISION

P1	21.06.23	Issued for Section 5
I/R	DATE	DESCRIPTION

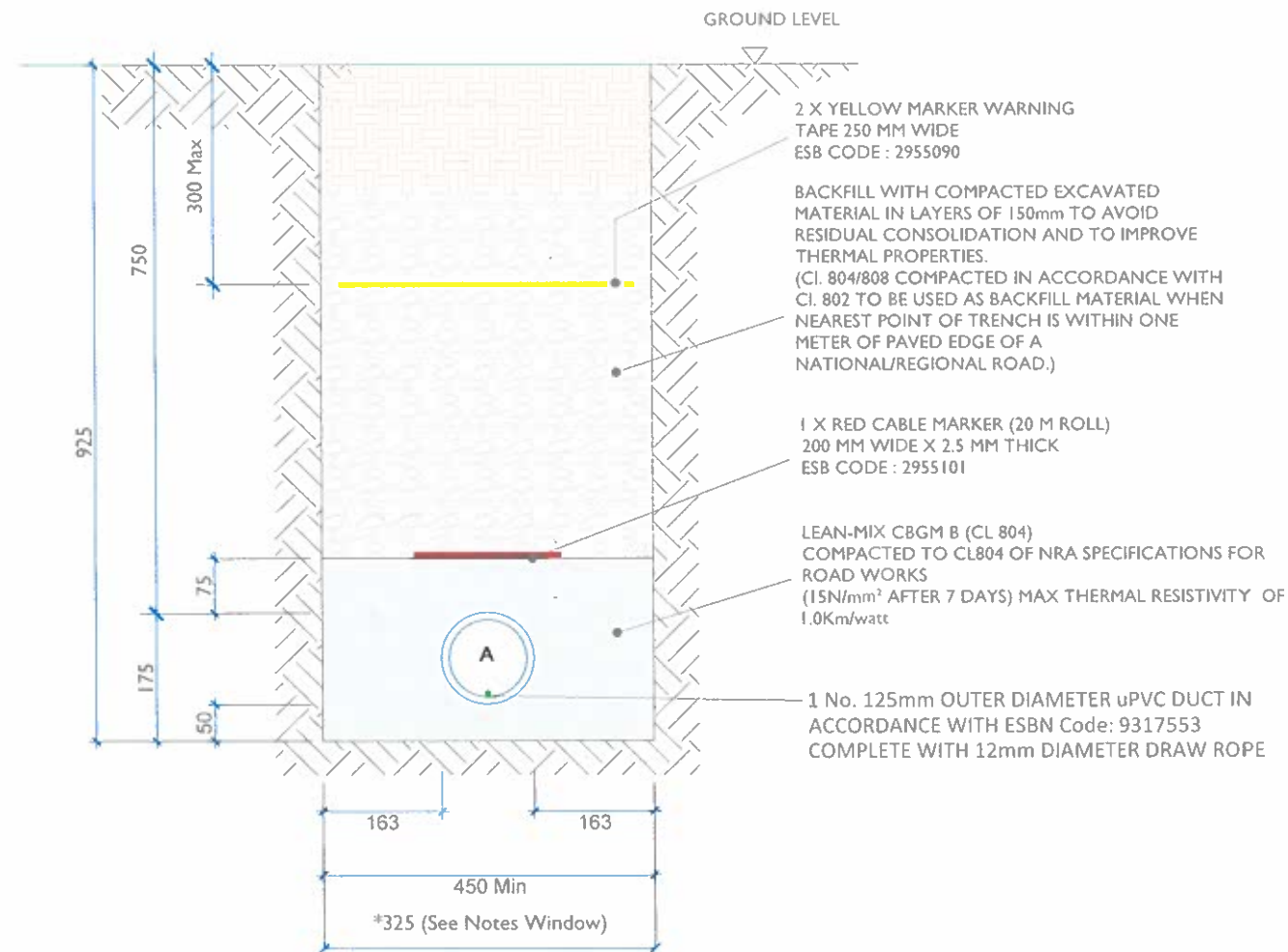

Typical Section Through Grasslands

SCALE 1:10

Note:

- This drawing is to be read in conjunction with relevant drawings, specifications and reports
- Dimensions are in millimeters, unless noted otherwise
- Drawings are not to be scaled use figured dimensions only
- 325 mm trench width is also acceptable to ESBN

ALL REINSTATEMENT WORKS ARE TO BE IN ACCORDANCE WITH LANDOWNERS REQUIREMENTS

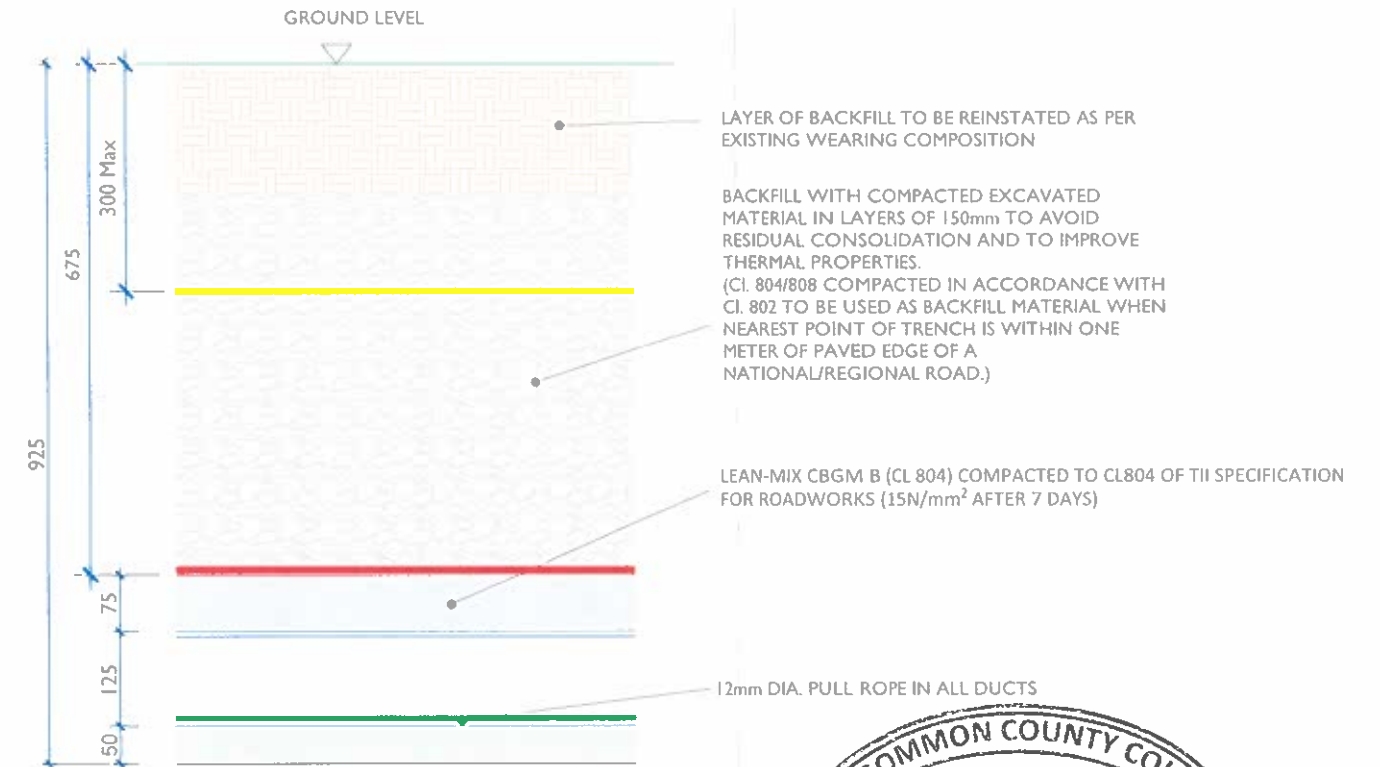

Typical Elevation Through Grasslands

SCALE 1:10



ISSUED FOR Section 5
NOT FOR CONSTRUCTION



Head Office
Beenreigh,
Abbeydorney,
Tralee, Co. Kerry
Ireland
Tel: 00353 66 7135710

CLIENT
Peter Gillooly

PROJECT
**Derm Wind Farm
10kV Grid Connection**

PROJECT NUMBER
05-727

SHEET NUMBER
05727-DR-305

SHEET TITLE
**Typical Ducting through
Grassland - Section & Elevations**

DRAWING STATUS
Section 5

ISSUE/REVISION

I/R	DATE	DESCRIPTION
P1	21.06.23	Issued for Section 5

Reinstatement details based on Guidelines for Managing Openings in Public Roads - SD7

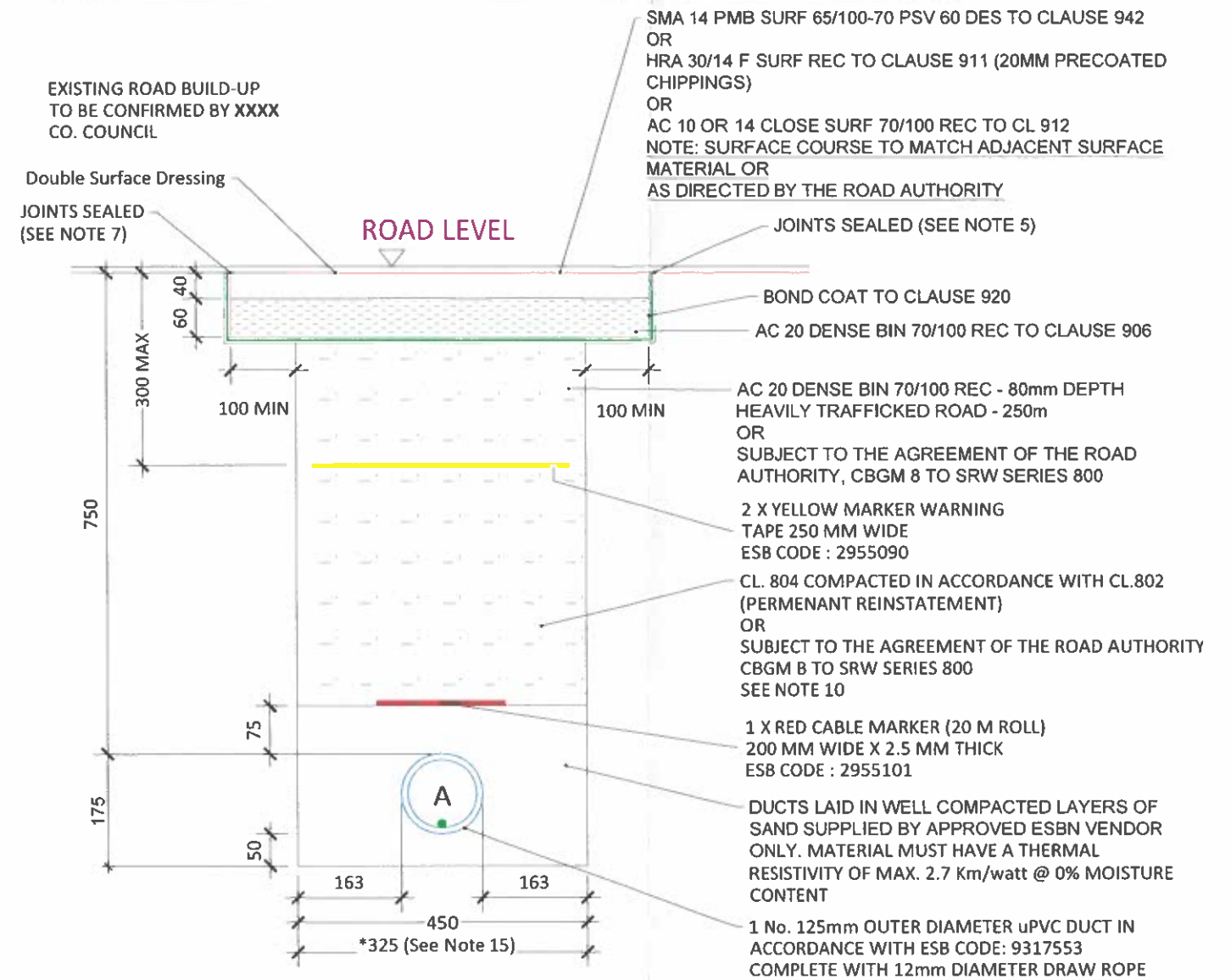

Typical Section Through Permanent Reinstatement of Transverse Openings

SCALE 1:10

1. Refer to Guidelines for managing Openings in Public Roads (Purple Book - April 2017), Chapter 6 'Specifications for guidance on Duct type / colour and Marker Tape type / colour.
2. All bound edges shall be saw cut to expose the full vertical thickness of each layer prior to excavation. All edges shall be essentially straight, smooth and vertical.
3. Where a temporary surface has been used, material shall be planned out to the depth specified in this drawing. The new permanent surface shall be machined laid and mechanically compacted with a vibrating roller.
4. Where the trimmed edge of excavation is within 400mm* of a joint / edge, ironwork or other reinstatement, this trimmed edge shall be extended to include same and the area of reinstatement shall be extended accordingly (* increase to 800mm where this is pre-existing practice).
5. Any damaged area adjacent to the opening and resulting from the excavation operation shall be included within the area to be reinstated.
6. Clause 808 or Cement Bound Granular Material surface to be sprayed per clause 920 prior to application of Asphalt Concrete Layer.
7. Joint sealer shall be a hot 50 pen bitumen binder or cold thixotropic bitumen 50 -70 pen to be applied to all vertical cuts in accordance with B.S.594987 prior to application of bituminous materials.
8. For roads without asphalt concrete surface (e.g. may be C1.804 with double surface dressing), the road authority may as its discretion permit the temporary reinstatement surface of asphalt concrete to be regulated in lieu of excavation and reinstatement; and subsequently surface dressed.
9. On highly trafficked roads services must have a minimum cover of 750mm.
10. Where required by the Road authority the trench may be reinstated with a Cement Bound Granular Material.
11. All reinstatement works are to be in accordance with local area engineers requirements and guidelines for managing openings in public roads
12. This drawing is to be read in conjunction with relevant drawings, specifications and reports.
13. Dimensions are in millimeters, unless noted otherwise.
14. Drawings are not to be scaled use figured dimensions only.
15. 325 mm trench width is also acceptable to ESNB provided trench compaction measures are in accordance with the DDTAS Purple Book Section 6.3.5 requirements (guidelines for managing openings in public roads) or TII specification CC-PAV 04-007 (2019) guidelines for reinstatement of openings in National roads, as appropriate.

tion and reinstatement; and subsequently surface

26 JUN 2023

PLANNING SECTION

n CC-PAY 04-00742019) guidelines for reinstatem

Reinstatement details based on Guidelines for Managing Openings in Public Roads - SD4

EXISTING ROAD BUILD-UP
TO BE CONFIRMED BY XXXX
CO. COUNCIL

SMA 14 PMB SURF 65/100-70 PSV 60 DES TO CLAUSE 942
OR
HRA 30/14 F SURF REC TO CLAUSE 911 (20MM PRECOATED
CHIPPINGS)
OR
AC 10 OR 14 CLOSE SURF 70/100 REC TO CL 912
NOTE: SURFACE COURSE TO MATCH ADJACENT SURFACE
MATERIAL OR
AS DIRECTED BY THE ROAD AUTHORITY

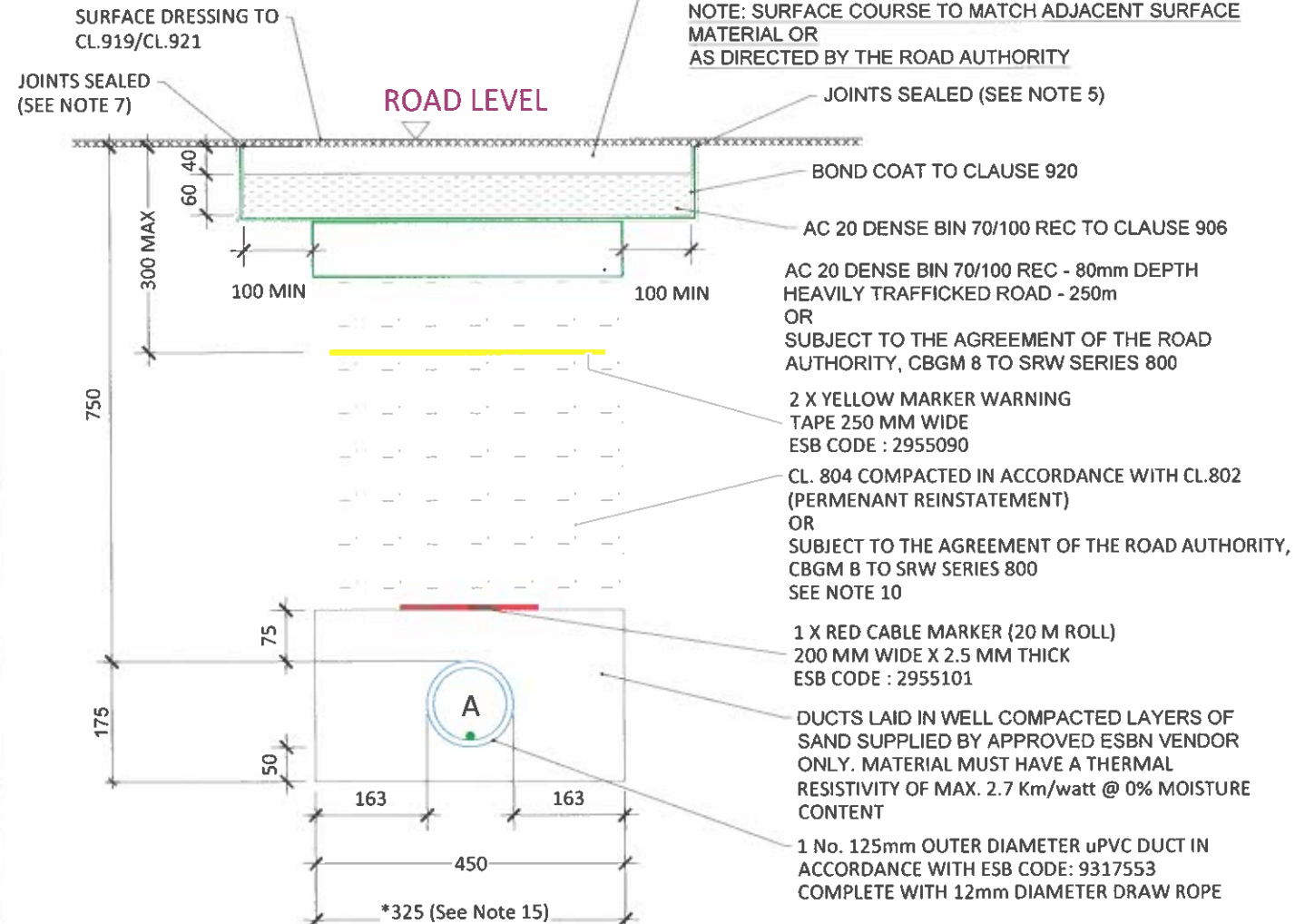

Typical Section Through Permanent Reinstatement of Longitudinal Opening in Roadway

SCALE 1:10

Note:

1. Refer to Guidelines for managing Openings in Public Roads (Purple Book - April 2017), Chapter 6 'Specifications' for guidance on Duct type / colour and Marker Tape type / colour.
2. All bound edges shall be saw cut to expose the full vertical thickness of each layer prior to excavation. All edges shall be essentially straight, smooth and vertical.
3. Where a temporary surface has been used, material shall be planed out to the depth specified in this drawing. The new permanent surface shall be machined laid and mechanically compacted with a vibrating roller.
4. Where the trimmed edge of excavation is within 400mm* of a joint / edge, ironwork or other reinstatement, this trimmed edge shall be extended to include same and the area of reinstatement shall be extended accordingly (* increase to 800mm where this is pre-existing practice).
5. Any damaged area adjacent to the opening and resulting from the excavation operation shall be included within the area to be reinstated.
6. Clause 808 or Cement Bound Granular Material surface to be sprayed per clause 920 prior to application of Asphalt Concrete Layer.
7. Joint sealer shall be a hot 50 pen bitumen binder or cold thixotropic bitumen 50-70 pen to be applied to all vertical cuts in accordance with B.S.594987 prior to application of bituminous materials.
8. For roads without asphalt concrete surface (e.g. may be Cl.804 with double surface dressing), the road authority may as its discretion permit the temporary reinstatement surface of asphalt concrete to be regulated in lieu of excavation and reinstatement, and subsequently surface dressed.
9. On highly trafficked roads services must have a minimum cover of 750mm.
10. Where required by the Road authority the trench may be reinstated with a Cement Bound Granular Material.
11. All reinstatement works are to be in accordance with local area engineers requirements and guidelines for managing openings in public roads
12. This drawing is to be read in conjunction with relevant drawings, specifications and reports.
13. Dimensions are in millimeters, unless noted otherwise.
14. Drawings are not to be scaled use figured dimensions only.
15. 325 mm trench width is also acceptable to ESNB provided trench compaction measures are in accordance with the DDTAS Purple Book Section 6.3.5 requirements (guidelines for managing openings in public roads) or TII specification CC-PAV 04-007 (2019) guidelines for reinstatement of openings in National roads, as appropriate.

Reinstatement details based on Guidelines for Managing Openings in Public Roads - SD5

EXISTING ROAD BUILD-UP
TO BE CONFIRMED BY
XXXX CO. COUNCIL

SURFACE DRESSING TO
CL.919/CL.921

JOINTS SEALED
(SEE NOTE 7)

75MM COMPACTED DEPTH OF AC 20 HDM
BIN 70/100 REC TO CL.906

JOINTS SEALED (SEE NOTE 5)

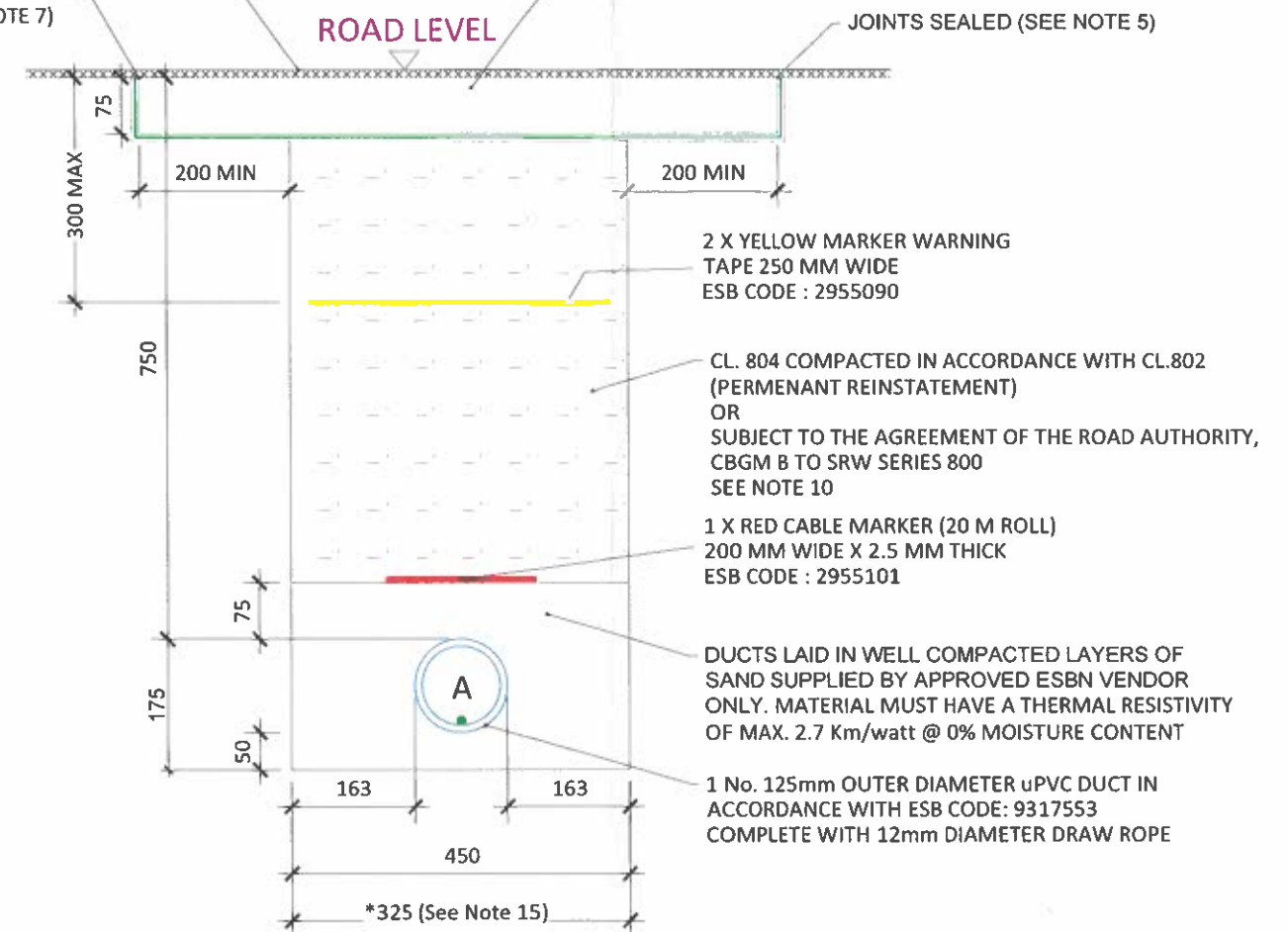

Typical Section Through Permanent Reinstatement of Longitudinal Opening in Dressed Rural Unbound Roadway

SCALE 1:10

ISSUED FOR SECTION 5
NOT FOR CONSTRUCTION



Head Office
Beenreigh,
Abbeydorney,
Tralee, Co. Kerry
Ireland
Tel: 00353 66 7135710

CLIENT
Peter Gillooly

PROJECT
Derm Wind Farm
10kV Grid Connection

PROJECT NUMBER
05-727

SHEET NUMBER
05727-DR-306

SHEET TITLE
10kV Ducting through Roadway
Permanent Reinstatement

DRAWING STATUS
Section 5

ISSUE/REVISION

ISSUE/REVISION		
P1	16.06.23	Issued for Section 5
I/R	DATE	DESCRIPTION

Roscommon County Council
Aras an Chontae
Roscommon
09066 37100

27/08/2023 11:57:20

Receipt No. : L01/0/223432

[REDACTED]
C/O TLI GROUP
UNIT 1, BORG COMMERCIAL PARK
MONAVALLEY
TRALEE, CO. KERRY

EXEMPTED DEVELOPMENT

PLANNING APPLICATION FEES	80.00
GOODS	80.00
VAT Exempt/Non-vatable	
DED 582	

Total : 80.00 EUR

Tendered :
Cheque
500007 80.00

Change : 0.00

Issued By : Louis Carroll
From : Central Cash Office

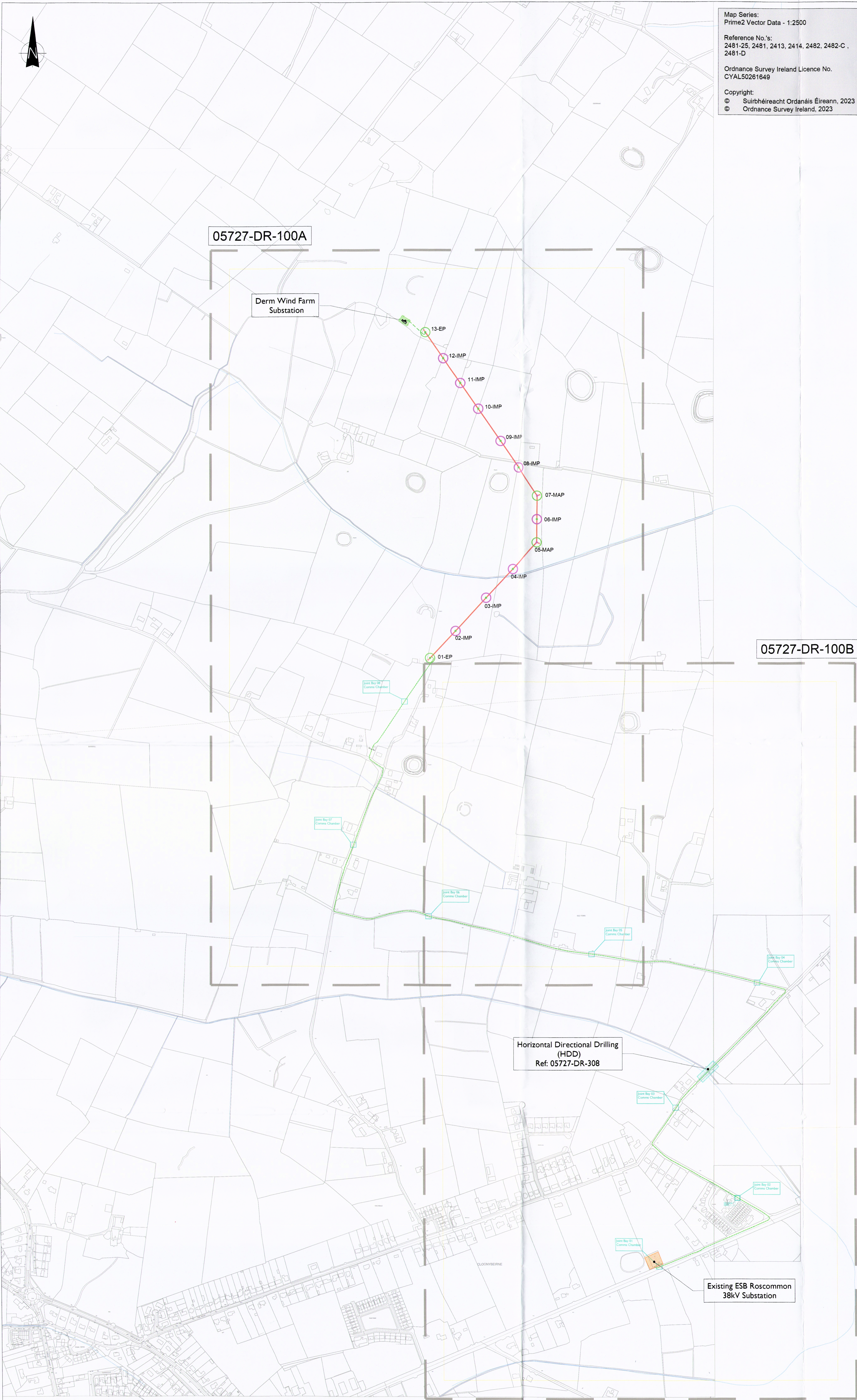

Map Series:
Prime2 Vector Data - 1:2500

Reference No.'s:
2481-25, 2481, 2413, 2414, 2482, 2482-C,
2481-D

Ordnance Survey Ireland Licence No.
CYAL50261649

Copyright:
© Suirbhéireacht Ordanáis Éireann, 2023
© Ordnance Survey Ireland, 2023

LEGEND: -	
Proposed Overhead Line Route (1km)	<div></div>
Proposed Underground cable Route (4.3km)	<div></div>
River Network	<div></div>
IMP Pole	<div></div>
EP Pole	<div></div>
MAP Pole	<div></div>
Kilkenny 38kV Substation	<div></div>
Derm Wind Farm Substation	<div></div>
Horizontal Directional Drilling (HDD)	<div></div>
Joint Bays	<div></div>

NOTES: -



Head Office
Beenreigh,
Abbeydorney,
Tralee, Co. Kerry
Ireland
Tel: 00353 66 7135710

Regional Office
Basepoint Business Centre
Stroudley Road, Basingstoke,
Hampshire,
RG24 8UP, UK
Tel: 00 44 1256406664

PROJECT

**Derm Wind Farm
10kV Grid Connection**

CLIENT

Peter Gillooly

CONSULTANTS



ISSUE/REVISION		
P1	21.06.23	Issued for Section 5
I/R	DATE	DESCRIPTION

PROJECT NUMBER

05-727

SHEET TITLE

**Overall Site Layout Plan
10kV Grid Connection**

SHEET NUMBER

05727-DR-100A

Overall Site Layout Plan
Scale : 1:5000



Image 1 : Bridge



Image 2 : Typical Drilling Rig and Launch Pit



Head Office
Beenreigh,
Abbeydorney,
Tralee, Co. Kerry
Ireland
Tel: 00353 66 7135710

Regional Office
Basepoint Business Centre
Stroudley Road, Basingstoke
Hampshire,
RG24 8UP, UK
Tel: 00 44 1256406664

PROJECT

Derm Wind Farm 10kV Grid Connection

CLIENT

Peter Gillooly

CONSULTANTS

NOTES: -

1. All excavations to be carried out with reference document 'Avoiding danger from underground services'
2. All relevant permissions to be in place prior to commencement of HDD works
3. Design is based on topographical survey completed by Client
4. Coordinate system is Irish Transverse Mercator (ITM)

LEGEND: -

- Proposed 10kV UG Route



ISSUE/REVISION

P1	21.06.23	Issued for Section 5
I/R	DATE	DESCRIPTION

PROJECT NUMBER

05-727

SHEET TITLE

10kV Circuit Horizontal Drilling Design

SHEET NUMBER

05727-DR-308

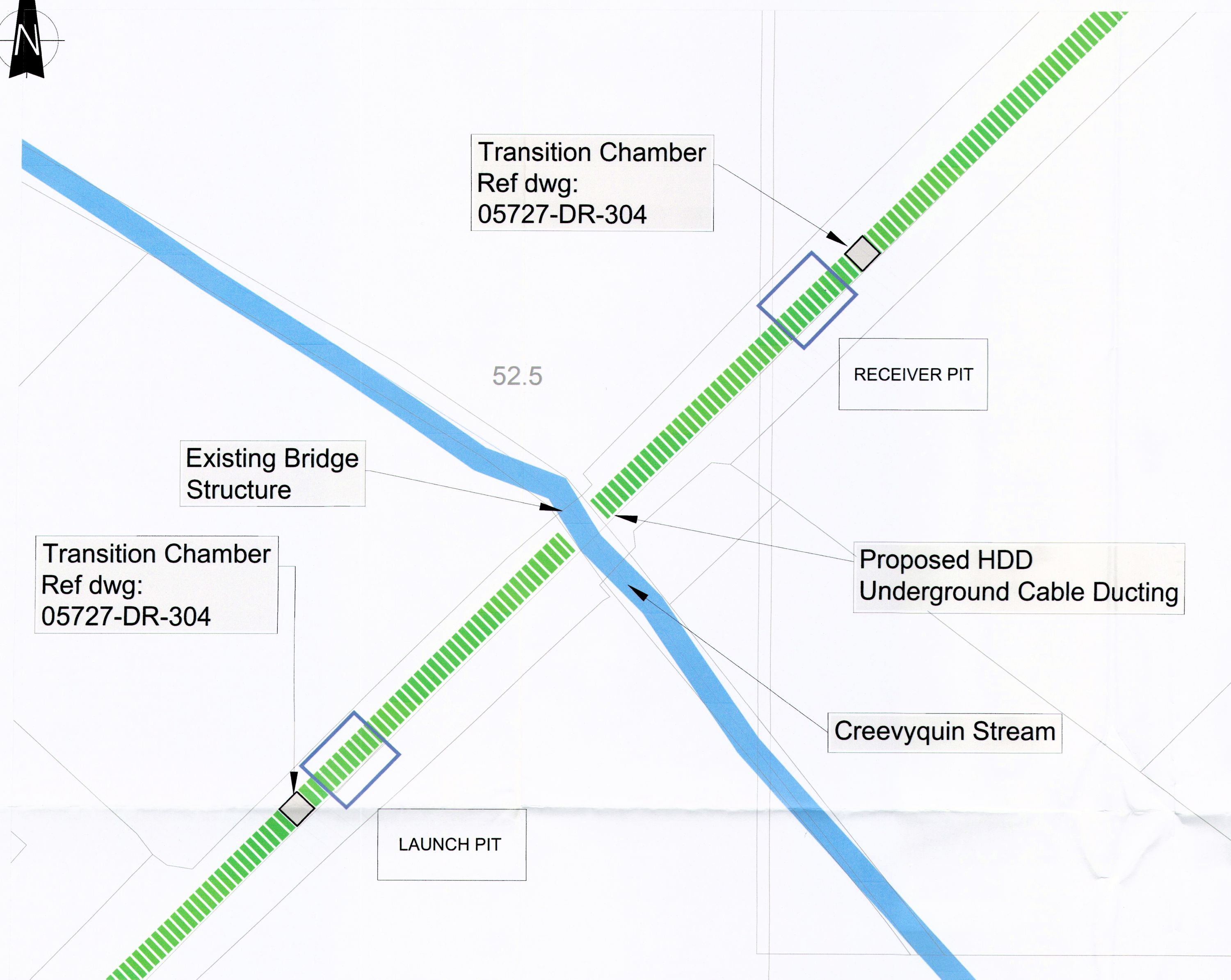

Plan View - Horizontal Drilling Design

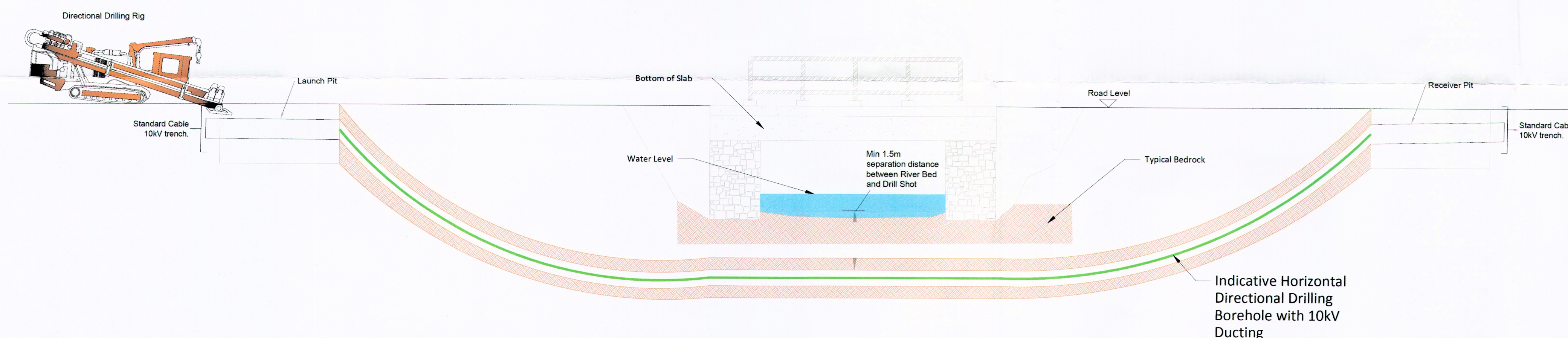
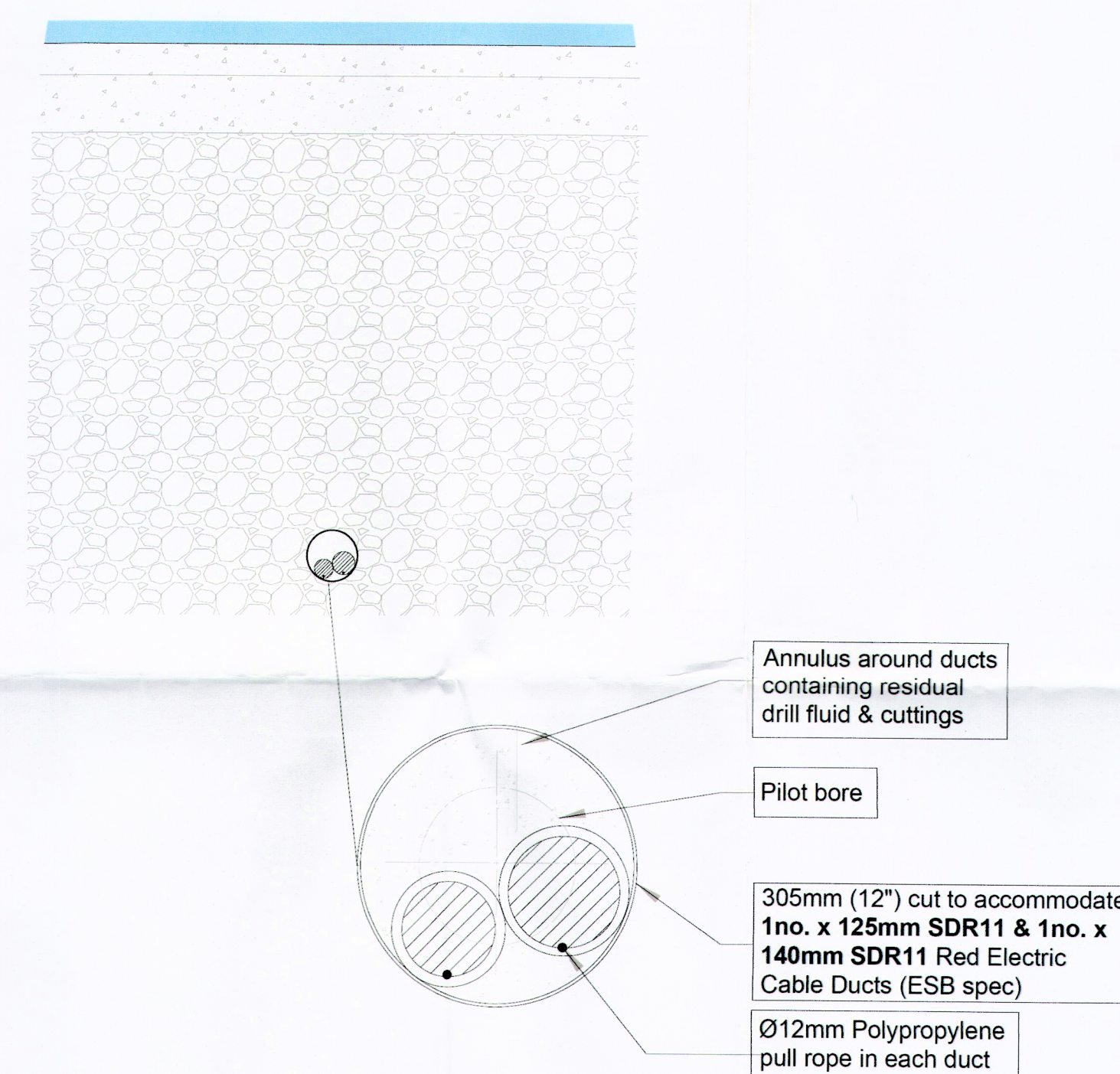

Land Profile for Designed HDD

Scale: 1:2500

Map Series:
Prime2 Vector Data - 1:2500

Reference No.'s:
2481-25, 2481, 2413, 2414, 2482, 2482-C,
2481-D

Ordnance Survey Ireland Licence No.
CYAL50261649

Copyright:
© Suirbhéireacht Ordánais Éireann, 2007
© Ordnance Survey Ireland, 2003

ISSUED FOR SECTION 5.
NOT FOR CONSTRUCTION

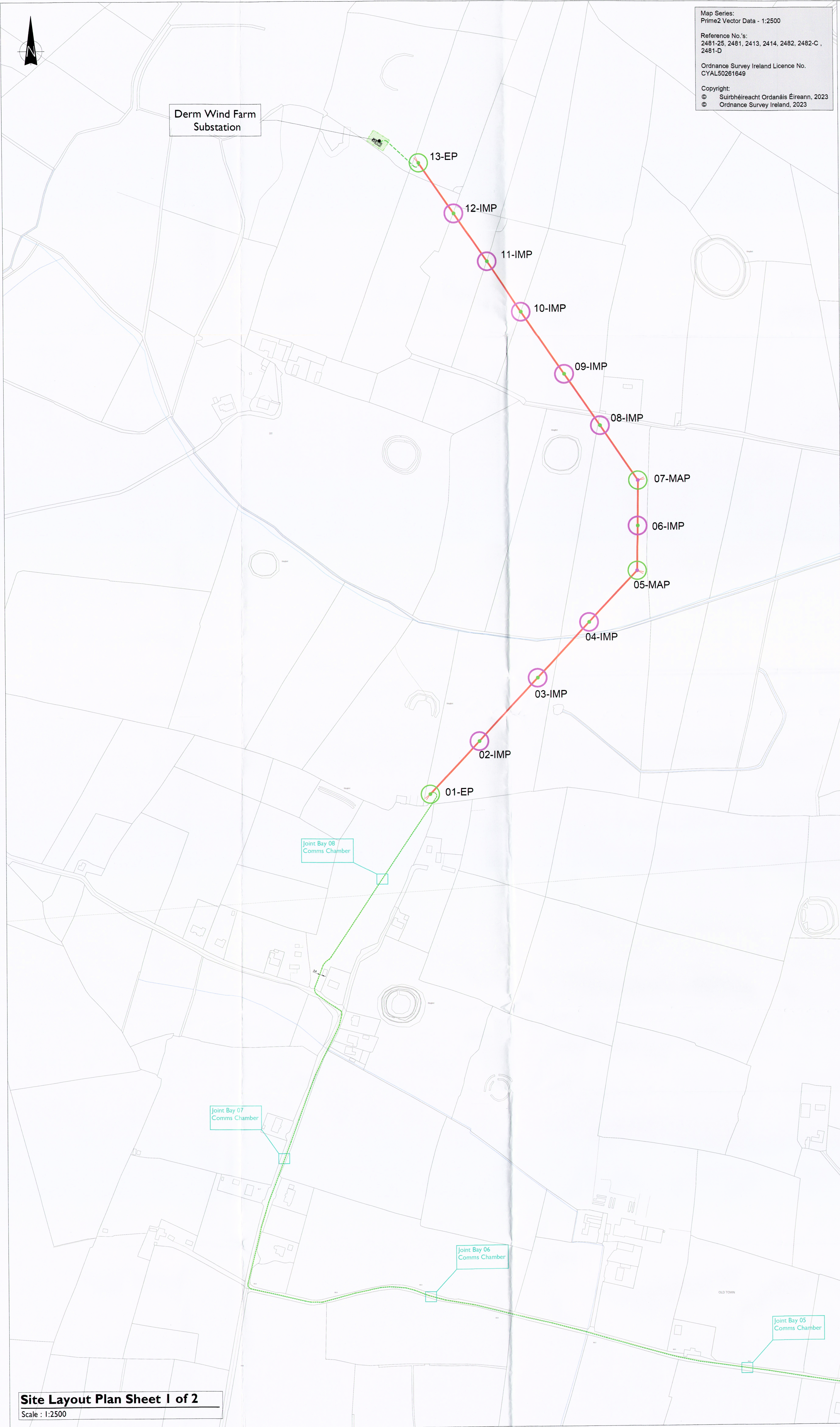

Map Series:
Prime2 Vector Data - 1:2500

Reference No.'s:
2481-25, 2481, 2413, 2414, 2482, 2482-C ,
2481-D

Ordnance Survey Ireland Licence No.
CYAL50261649

Copyright:
© Suirbhéireacht Ordnáis Éireann, 2023
© Ordnance Survey Ireland, 2023

LEGEND: -	
Proposed Overhead Line Route (1km)	<div></div>
Proposed Underground cable Route (4.3km)	<div></div>
River Network	<div></div>
IMP Pole	<div></div>
EP Pole	<div></div>
MAP Pole	<div></div>
Kilkeny 38kV Substation	<div></div>
Derm Wind Farm Substation	<div></div>
Horizontal Directional Drilling (HDD)	<div></div>
Joint Bays	<div></div>

NOTES: -

Head Office
Beenrigh,
Abbeydorney,
Tralee, Co. Kerry
Ireland
Tel: 00353 66 7135710

Regional Office
Basepoint Business Centre
Stroudley Road, Basingstoke,
Hampshire,
RG24 8UP, UK
Tel: 00 44 1256406664

PROJECT

Derm Wind Farm
10kV Grid Connection

CLIENT

Peter Gillooly

CONSULTANTS



ISSUE/REVISION

P1	21.06.23	Issued for Section 5 Planning
I/R	DATE	DESCRIPTION

PROJECT NUMBER

05-727

SHEET TITLE

Site Layout Plan
10kV Grid Connection

SHEET NUMBER

05727-DR-100B



Map Series:
Prime2 Vector Data - 1:2500

Reference No.'s:
2481-25, 2481, 2413, 2414, 2482, 2482-C ,
2481-D

Ordnance Survey Ireland Licence No.
CYAL50261649

Copyright:
© Suirbhéireacht Ordanáis Éireann, 2023
© Ordnance Survey Ireland, 2023

LEGEND: -	
Proposed Overhead Line Route (1km)	<div></div>
Proposed Underground cable Route (4.3km)	<div></div>
River Network	<div></div>
IMP Pole	<div></div>
EP Pole	<div></div>
MAP Pole	<div></div>
Kilkenny 38kV Substation	<div></div>
Derm Wind Farm Substation	<div></div>
Horizontal Directional Drilling (HDD)	<div></div>
Joint Bays	<div></div>

NOTES: -



Head Office
Beenreigh,
Abbeydorney,
Tralee, Co. Kerry
Ireland
Tel: 00353 66 7135710

Regional Office
Basepoint Business Centre
Stroudley Road, Basingstoke,
Hampshire,
RG24 8UP, UK
Tel: 00 44 1256406664

PROJECT

**Derm Wind Farm
10kV Grid Connection**

CLIENT

Peter Gillooly

CONSULTANTS



ISSUE/REVISION		
P1	21.06.23	Issued for Section 5
I/R	DATE	DESCRIPTION

PROJECT NUMBER

05-727

SHEET TITLE

**Site Layout Plan
10kV Grid Connection**

SHEET NUMBER

05727-DR-100C