

ARIGNA CEMETERY EXTENSION.

NO. OF GRAVES:

- Plot A. — 319.
- Plot B. — 207.
- Plot C. — 235.
- Plot D. — 249.
- SIDE PLOTS. — 36.
- total — 1076

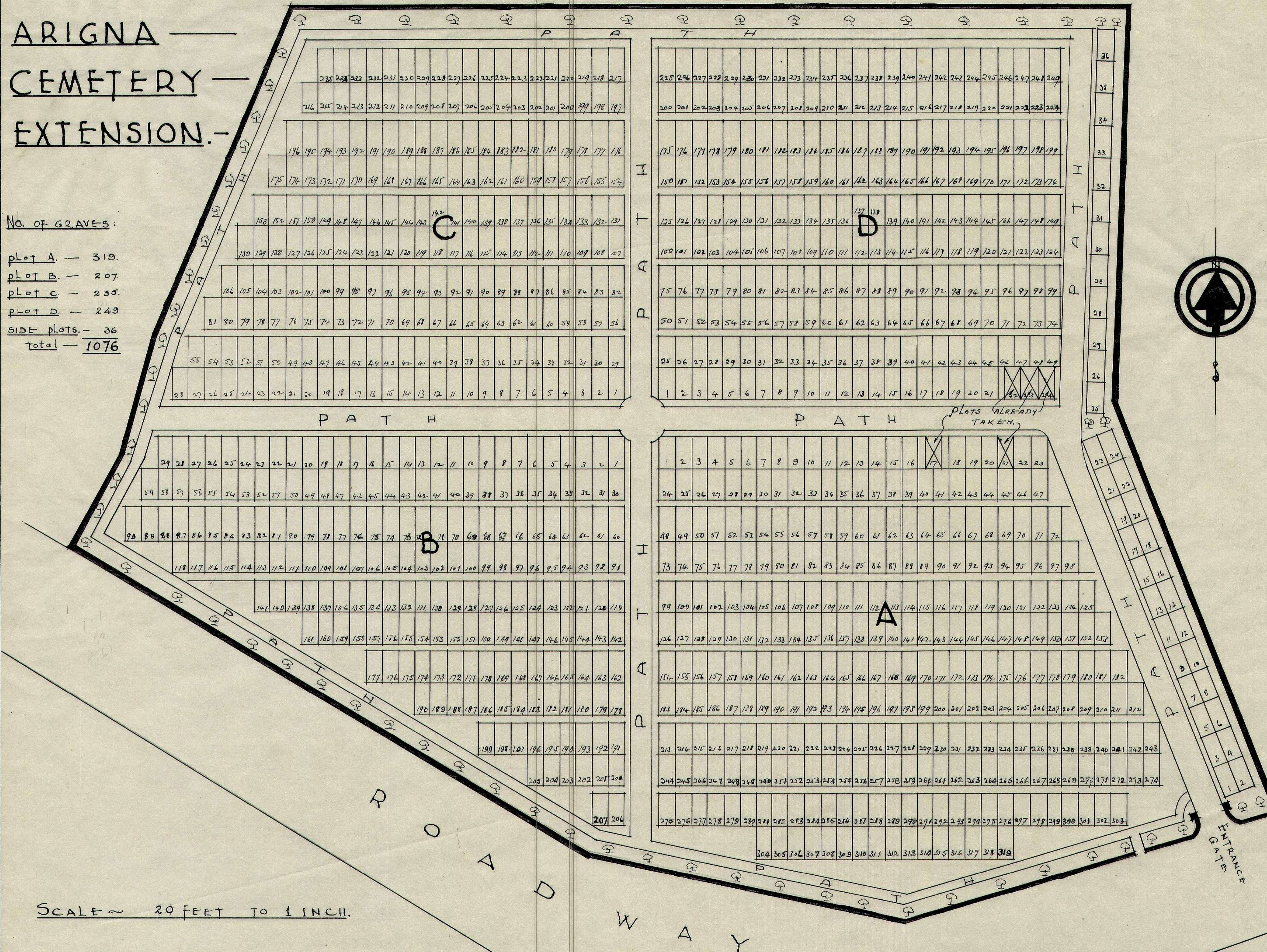

SCALE ~ 20 FEET TO 1 INCH.

DATE ~ MARCH 1950. (revised layout of grave spaces)

M. NERNEY B.E.
CO. ENGINEER.
ROSCOMMON.