

DATE: 9 August 2024
DESIGNER: N.Grealish
PROJECT No: R0
PROJECT NAME: Monksland Housing Development, Athlone



Outdoor Lighting Report

The lighting design has achieved the following Lighting Standards:
IS EN 13201- 2:2015 / BS5489-1:2020

“Electric Skyline confirms that this Design complies with relevant Lighting Standards. However as the Design was prepared on a Desktop basis, Electric Skyline assumes no responsibility or liability for any errors or omissions which may occur due to varying conditions on the Project site. This Design is provided on a provisional basis only, with no guarantees of completeness or accuracy until on-site surveys are completed by associated Contractors and all Safety Rules and Codes of Practice have been taken into consideration.”

PREPARED BY: Electric Skyline Ltd
CRF House,
Dalton St,
Claremorris,
Co. Mayo,
F12 N2Y2
e-mail: info@electricsskyline.ie
website: www.electricskyline.ie

Layout Report

General Data

Dimensions in Metres Angles in Degrees
Grid Origin -14.0m x 12.6m
Area 249.3m x 181.6m
Sample Spacing 1.49m x 1.49m

Luminaires



Luminaire A Data

Supplier	Urbis Schreder
Type	AXIA 3 EVO 1 5266 16 OSLON SQUARE GIANT@500mA WW 730 230V 02-53
Lamp(s)	16 OSLON SQUARE GIANT@500mA WW 730 230V 02-53-573 [CJOIO4STDA]
Lamp Flux (klm)	3.28
File Name	AXIA 3 EVO 1 5266 16 OSLON SQUARE GIANT 500mA WW 730 25W 7x4 III-Medi...
Maintenance Factor	0.87
Imax70,80,90(cd/klm)	1081.8, 207.1, 0.0
No. in Project	2



Luminaire B Data

Supplier	Urbis Schreder
Type	AXIA 3 EVO 1 5267 16 OSLON SQUARE GIANT@500mA WW 730 230V 02-53
Lamp(s)	16 OSLON SQUARE GIANT@500mA WW 730 230V 02-53-573 [CJOIO4STDA]
Lamp Flux (klm)	3.21
File Name	AXIA 3 EVO 1 5267 16 OSLON SQUARE GIANT 500mA WW 730 25W 7x5 III-Medi...
Maintenance Factor	0.87
Imax70,80,90(cd/klm)	950.2, 150.2, 0.0
No. in Project	16

Layout

ID	Type	X	Y	Height	Angle	Tilt	Cant	Out-reach	Target X	Target Y	Target Z
1	B	211.59	52.48	6.00	209.00	0.00	0.00	0.35			
2	B	195.27	63.00	6.00	42.00	0.00	0.00	0.35			
3	B	172.82	81.41	6.00	31.00	0.00	0.00	0.35			
4	B	174.68	99.17	6.00	190.00	0.00	0.00	0.35			
5	B	171.21	129.56	6.00	186.00	0.00	0.00	0.35			
6	A	176.95	138.78	6.00	96.00	0.00	0.00	0.35			
7	B	169.00	159.90	6.00	185.00	0.00	0.00	0.35			
8	B	146.52	87.04	6.00	270.00	0.00	0.00	0.35			
9	B	113.67	85.94	6.00	272.00	0.00	0.00	0.35			
10	B	86.55	84.88	6.00	270.00	0.00	0.00	0.35			
11	B	98.57	107.63	6.00	3.00	0.00	0.00	0.35			
12	B	70.45	74.17	6.00	181.00	0.00	0.00	0.35			
13	B	68.57	99.16	6.00	189.00	0.00	0.00	0.35			
14	B	69.68	128.73	6.00	165.00	0.00	0.00	0.35			
15	B	53.50	150.72	6.00	80.00	0.00	0.00	0.35			
16	B	96.37	130.64	6.00	8.00	0.00	0.00	0.35			
17	B	84.84	146.84	6.00	82.00	0.00	0.00	0.35			
18	A	48.53	111.20	6.00	93.00	0.00	0.00	0.35			

Horizontal Illuminance (lux)

Grid 1

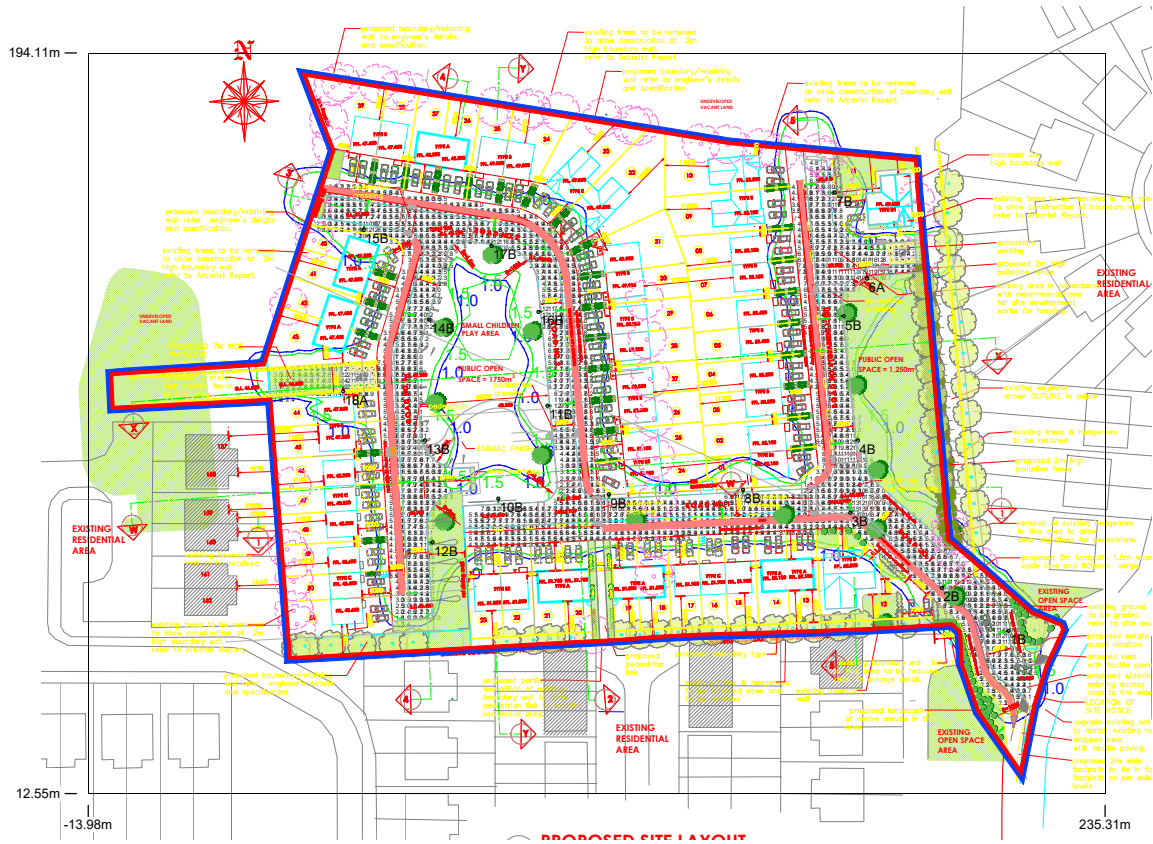

Results

Eav	6.35
Emin	1.30
E _{max}	27.23
E _{min} /E _{max}	0.05
E _{min} /E _{av}	0.20