

Roscommon Town “Putting the Spokes Back in the Wheel”

Public Realm Proposals

October 2022

For Planning



Rialtas
na hÉireann
Government
of Ireland

Tionscadal Éireann
Project Ireland
2040





Notes
Do not scale from this drawing.
All dimensions are drawn in millimetres.
Drawing & design copyright LUC.
Reproduction of this drawing in whole or in part is prohibited without prior permission.

- Proposed upstanding Kerb
- Proposed flush kerb
- Asphalt surfacing
- Natural stone paving
- Concrete paving
- Natural stone sett paving
- Cycleway surfacing
- Cycleway sett surfacing
- Insitu concrete surfacing
- Concrete sett surfacing
- Concrete plank surfacing with exposed aggregate surfacing
- Poured concrete surfacing
- Existing sett surfacing retained
- Proposed tactile paving
- Existing Lighting Column Location
- Proposed ornamental planting
- Proposed hedge planting
- Grass verge surfacing
- Proposed tree planting
- Existing tree planting retained
- Existing planting retained
- Existing grass retained
- Existing kerbline retained
- Site Boundary

Iss	Date	Description	Drn	Chk

LUC

LUC Manchester
6th Floor, 55 King Street, Manchester, M2 4LQ
+44 (0)161 537 5960
manchester@landuse.co.uk
www.landuse.co.uk

Project Roscommon Public Realm Enhancement & Cycleways Projects	
Client Roscommon County Council	
Scale @A1 NTS	Status For Planning
Drawing Title Public Realm Proposals Masterplan	

Job Nr 11395	Drawing Nr 11395_LD_MP_001	Issue
-----------------	-------------------------------	-------

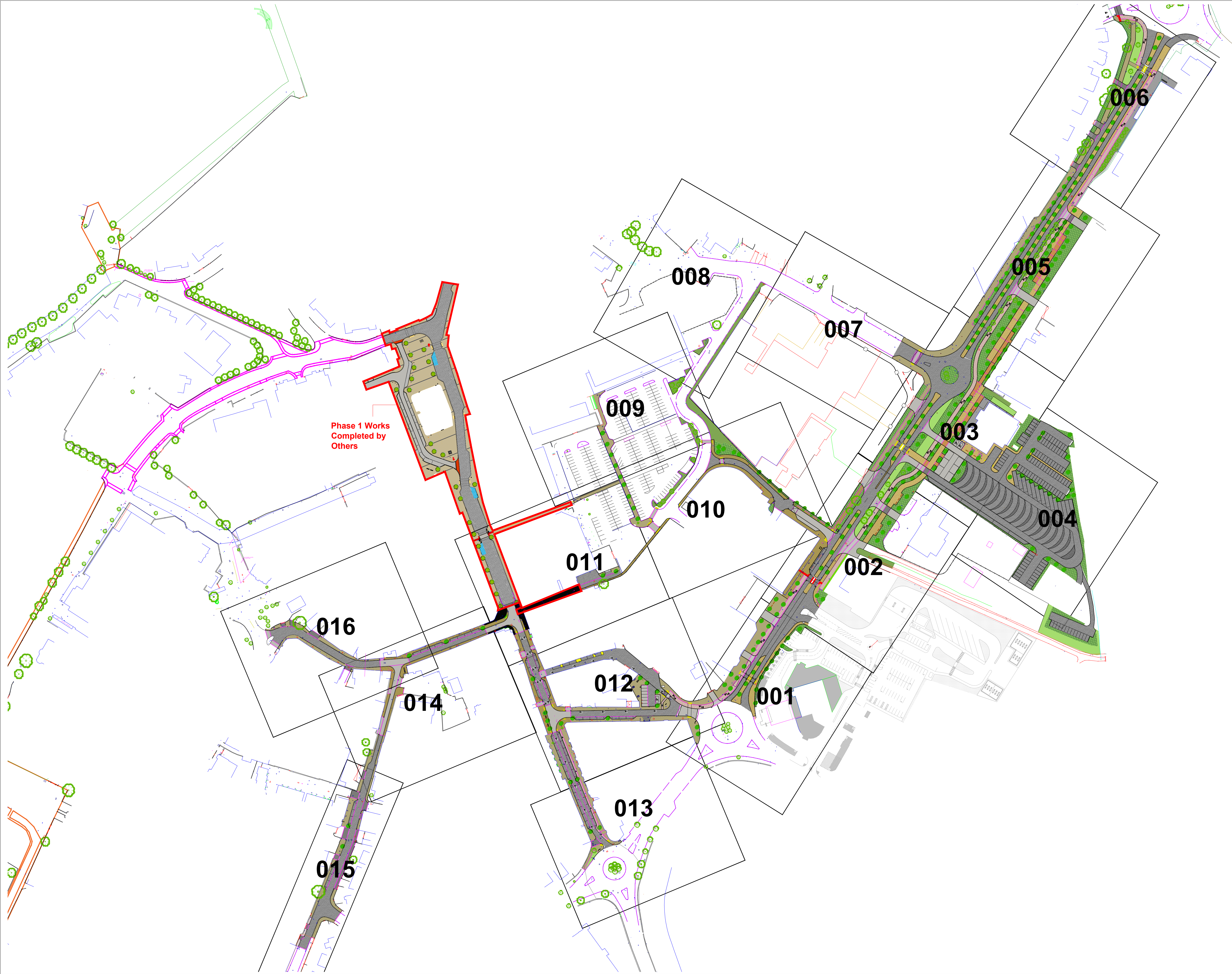

Notes
Do not scale from this drawing.
All dimensions are drawn in millimetres.
Drawing & design copyright LUC.
Reproduction of this drawing in whole or in part is prohibited without prior permission.

Iss	Date	Description	Drn	Chk	

LUC

LUC Manchester
6th Floor, 55 King Street, Manchester, M2 4LQ
+44 (0)161 537 5960
manchester@landuse.co.uk
www.landuse.co.uk











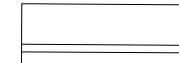

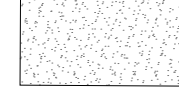
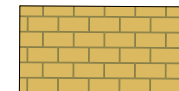
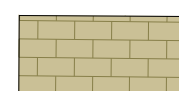



Project Roscommon Public Realm Enhancement & Cycleways Projects	
Client Roscommon County Council	
Scale @A1 NTS	Status For Planning
Drawing Title Public Realm Proposals Masterplan - Key Plan	

Job Nr 11395	Drawing Nr 11395_LD_KP_001	Issue
-----------------	-------------------------------	-------

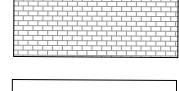
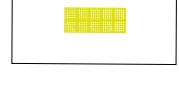
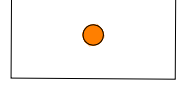
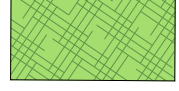

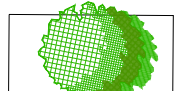
See drawing
11395_LD_HL_002
for details

Notes
Do not scale from this drawing.
All dimensions are drawn in millimetres.
Drawing & design copyright LUC.
Reproduction of this drawing in whole or in part is prohibited without prior permission.

-  Proposed upstanding Kerb
-  Proposed flush kerb
-  Asphalt surfacing
-  Natural stone paving
-  Concrete paving
-  Natural stone sett paving
-  Cycleway surfacing
-  Cycleway sett surfacing
-  Insitu concrete surfacing
-  Concrete sett surfacing
-  Concrete plank surfacing with exposed aggregate surfacing
-  Poured concrete surfacing
-  Existing sett surfacing retained
-  Proposed tactile paving
-  Existing Lighting Column Location
-  Proposed ornamental planting
-  Proposed hedge planting
-  Grass verge surfacing
-  Proposed tree planting
-  Existing tree planting retained
-  Existing planting retained
-  Existing grass retained
-  Existing kerbline retained

Iss	Date	Description	Drn	Chk



LUC Manchester
6th Floor, 55 King Street, Manchester, M2 4LQ
+44 (0)161 537 5960
manchester@landuse.co.uk
www.landuse.co.uk

Project
Roscommon Public Realm Enhancement & Cycleways Projects

Client
Roscommon County Council

Scale @A1
1:200

Status
For Planning

Drawing Title
Public Realm Proposals General Arrangement
(Sheet 1 of 16)

Job Nr 11395	Drawing Nr 11395_LD_HL_001	Issue
-----------------	-------------------------------	-------

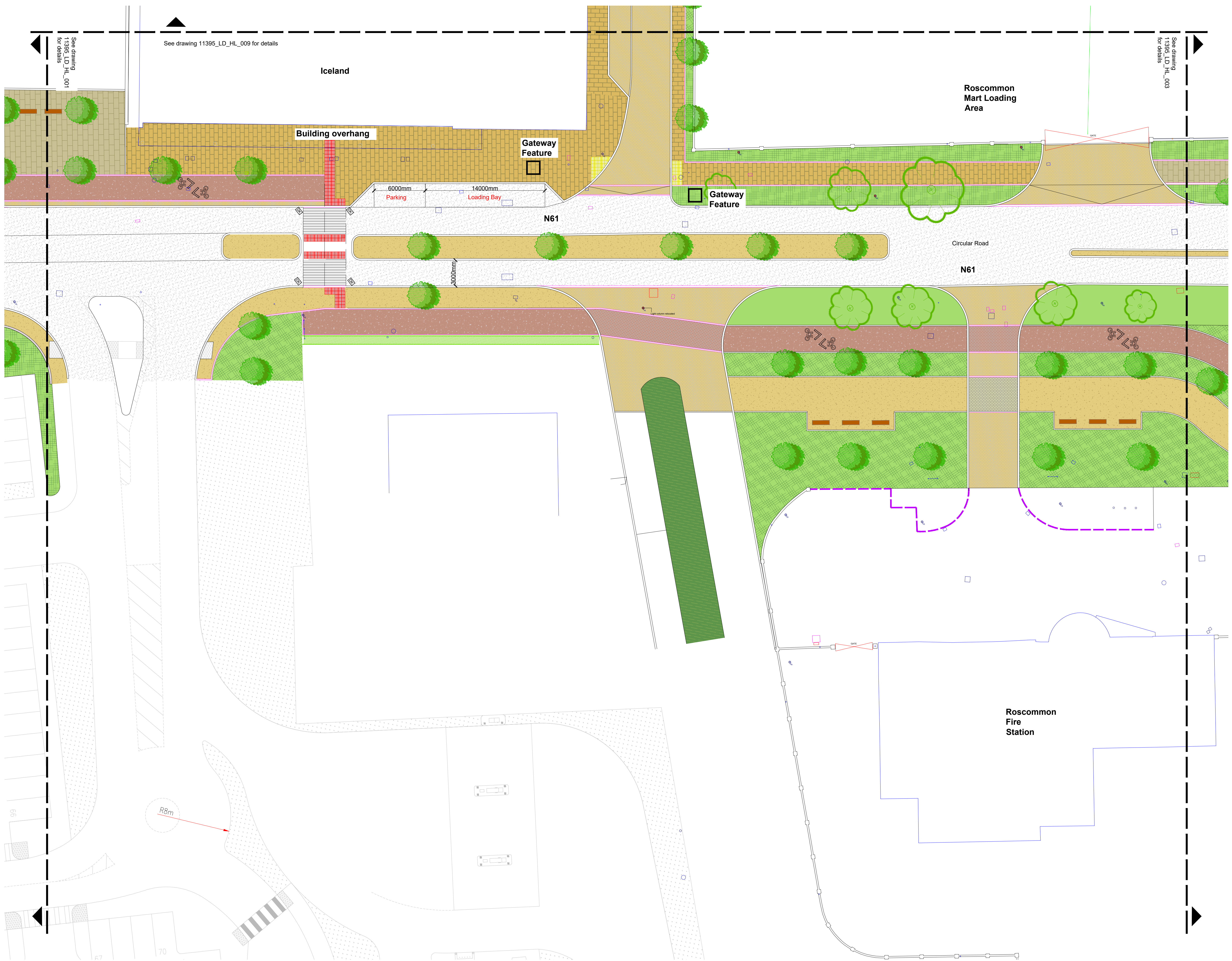

Notes
Do not scale from this drawing.
All dimensions are drawn in millimetres.
Drawing & design copyright LUC.
Reproduction of this drawing in whole or in part is prohibited without prior permission.

- | | |
|--|---|
| | Proposed upstanding Kerb |
| | Proposed flush kerb |
| | Asphalt surfacing |
| | Natural stone paving |
| | Concrete paving |
| | Natural stone sett paving |
| | Cycleway surfacing |
| | Cycleway sett surfacing |
| | Insitu concrete surfacing |
| | Concrete sett surfacing |
| | Concrete plank surfacing with exposed aggregate surfacing |
| | Poured concrete surfacing |
| | Existing sett surfacing retained |
| | Proposed tactile paving |
| | Existing Lighting Column Location |
| | Proposed ornamental planting |
| | Proposed hedge planting |
| | Grass verge surfacing |
| | Proposed tree planting |
| | Existing tree planting retained |
| | Existing planting retained |
| | Existing grass retained |
| | Existing kerbline retained |

[illegible]

LUC **LUC Manchester**
6th Floor, 55 King Street, Manchester, M2 4LQ
+44 (0)161 537 5960
manchester@landuse.co.uk
www.landuse.co.uk

Project
Roscommon Public Realm Enhancement &
Cycleways Projects

Client
Roscommon County Council

Scale @A1 1:200	Status For Planning
--------------------	------------------------

Drawing Title
Public Realm Proposals General Arrangement
(Sheet 2 of 16)

Job Nr 11395	Drawing Nr 11395_LD_HL_002	Issue
-----------------	-------------------------------	-------

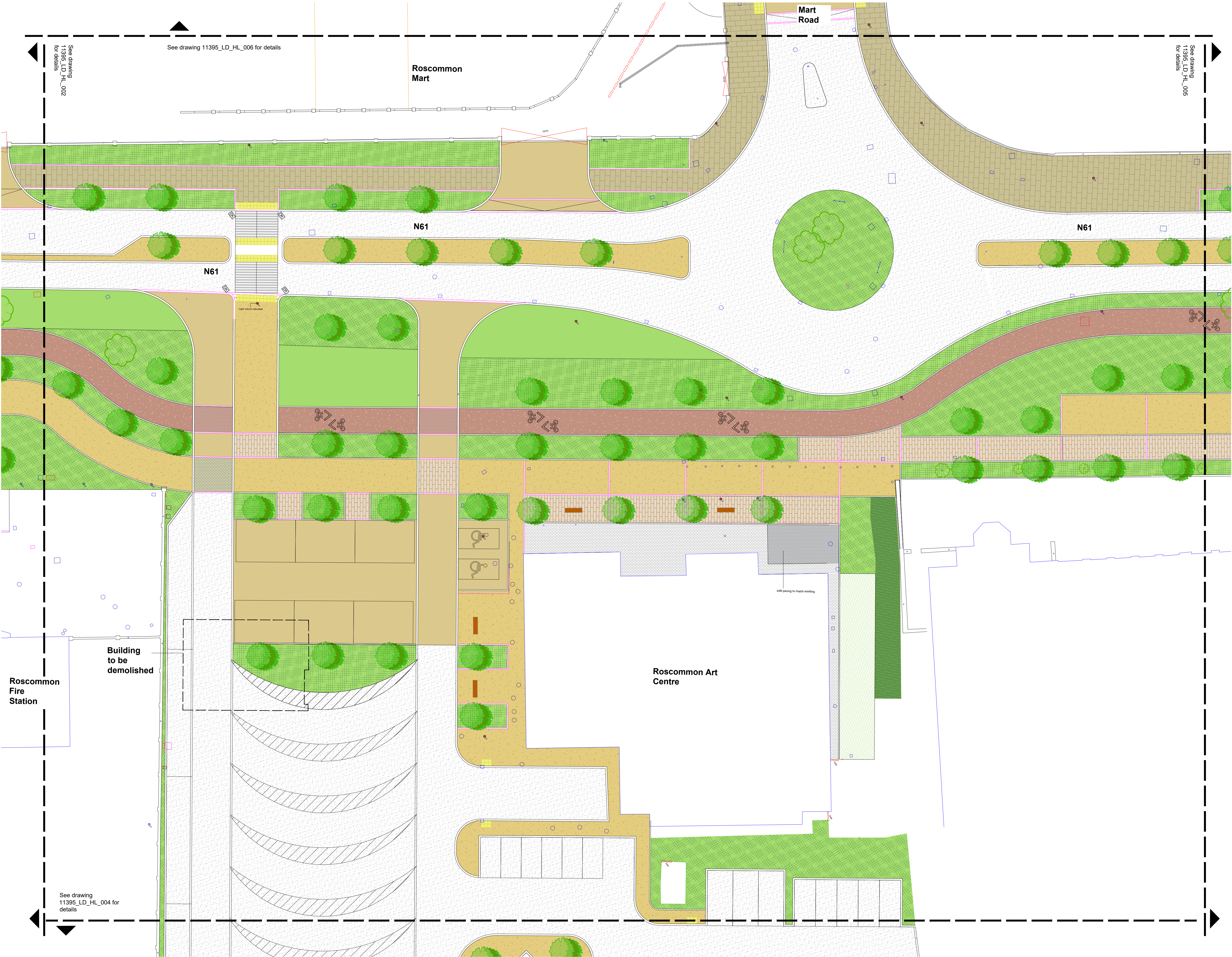

Notes
Do not scale from this drawing.
All dimensions are drawn in millimetres.
Drawing & design copyright LUC.
Reproduction of this drawing in whole or in part is prohibited without prior permission.

- Proposed upstanding Kerb
- Proposed flush kerb
- Asphalt surfacing
- Natural stone paving
- Concrete paving
- Natural stone sett paving
- Cycleway surfacing
- Cycleway sett surfacing
- Insitu concrete surfacing
- Concrete sett surfacing
- Concrete plank surfacing with exposed aggregate surfacing
- Poured concrete surfacing
- Existing sett surfacing retained
- Proposed tactile paving
- Existing Lighting Column Location
- Proposed ornamental planting
- Proposed hedge planting
- Grass verge surfacing
- Proposed tree planting
- Existing tree planting retained
- Existing planting retained
- Existing grass retained
- Existing kerbline retained

Iss	Date	Description	Drn	Chk

LUC

LUC Manchester
6th Floor, 55 King Street, Manchester, M2 4LQ
+44 (0)161 537 5960
manchester@landuse.co.uk
www.landuse.co.uk

Project Roscommon Public Realm Enhancement & Cycleways Projects	
Client Roscommon County Council	
Scale @A1 1:200	Status For Planning
Drawing Title Public Realm Proposals General Arrangement (Sheet 3 of 16)	
Job Nr 11395	Drawing Nr 11395_LD_HL_003
Issue	

	Proposed upstanding Kerb
	Proposed flush kerb
	Asphalt surfacing
	Natural stone paving
	Concrete paving
	Natural stone sett paving
	Cycleway surfacing
	Cycleway sett surfacing
	Insitu concrete surfacing
	Concrete sett surfacing
	Concrete plank surfacing with exposed aggregate surfacing
	Poured concrete surfacing
	Existing sett surfacing retained
	Proposed tactile paving
	Existing Lighting Column Location
	Proposed ornamental planting
	Proposed hedge planting
	Grass verge surfacing
	Proposed tree planting
	Existing tree planting retained
	Existing planting retained
	Existing grass retained
	Existing kerbline retained



LUC **LUC Manchester**
6th Floor, 55 King Street, Manchester, M2 4LQ
+44 (0)161 537 5960
manchester@landuse.co.uk
www.landuse.co.uk

Project
Roscommon Public Realm Enhancement & Cycleways Projects

Client
Roscommon County Council

Scale @A1 1:200	Status For Planning
--------------------	------------------------

Drawing Title
Public Realm Proposals General Arrangement
(Sheet 5 of 16)

Job Nr 11395	Drawing Nr 11395_LD_HL_005	Issue
-----------------	-------------------------------	-------



See drawing
11395_LD_HL_003
for details

- Notes**
Do not scale from this drawing.
All dimensions are drawn in millimetres.
Drawing & design copyright LUC.
Reproduction of this drawing in whole or in part is prohibited without prior permission.
- Proposed upstanding Kerb
 - Proposed flush kerb
 - Asphalt surfacing
 - Natural stone paving
 - Concrete paving
 - Natural stone sett paving
 - Cycleway surfacing
 - Cycleway sett surfacing
 - Insitu concrete surfacing
 - Concrete sett surfacing
 - Concrete plank surfacing with exposed aggregate surfacing
 - Poured concrete surfacing
 - Existing sett surfacing retained
 - Proposed tactile paving
 - Existing Lighting Column Location
 - Proposed ornamental planting
 - Proposed hedge planting
 - Grass verge surfacing
 - Proposed tree planting
 - Existing tree planting retained
 - Existing planting retained
 - Existing grass retained
 - Existing kerbline retained

Iss	Date	Description	Drn	Chk

LUC

LUC Manchester
6th Floor, 55 King Street, Manchester, M2 4LQ
+44 (0)161 537 5960
manchester@landuse.co.uk
www.landuse.co.uk

Project

Roscommon Public Realm Enhancement & Cycleways Projects

Client

Roscommon County Council

Scale @A1

1:200

Status

For Planning

Drawing Title

Public Realm Proposals General Arrangement (Sheet 6 of 16)

Job Nr

11395

Drawing Nr

11395_LD_HL_006

Issue



Notes
Do not scale from this drawing.
All dimensions are drawn in millimetres.
Drawing & design copyright LUC.
Reproduction of this drawing in whole or in part is prohibited without prior permission.

- Proposed upstanding Kerb
- Proposed flush kerb
- Asphalt surfacing
- Natural stone paving
- Concrete paving
- Natural stone sett paving
- Cycleway surfacing
- Cycleway sett surfacing
- Insitu concrete surfacing
- Concrete sett surfacing
- Concrete plank surfacing with exposed aggregate surfacing
- Poured concrete surfacing
- Existing sett surfacing retained
- Proposed tactile paving
- Existing Lighting Column Location
- Proposed ornamental planting
- Proposed hedge planting
- Grass verge surfacing
- Proposed tree planting
- Existing tree planting retained
- Existing planting retained
- Existing grass retained
- Existing kerbline retained

Iss	Date	Description	Drn	Chk

LUC Manchester
6th Floor, 55 King Street, Manchester, M2 4LQ
+44 (0)161 537 5960
manchester@landuse.co.uk
www.landuse.co.uk

Project Roscommon Public Realm Enhancement & Cycleways Projects	
Client Roscommon County Council	
Scale @A1 1:200	Status For Planning
Drawing Title Public Realm Proposals General Arrangement (Sheet 8 of 16)	

Job Nr 11395	Drawing Nr 11395_LD_HL_008	Issue
-----------------	-------------------------------	-------

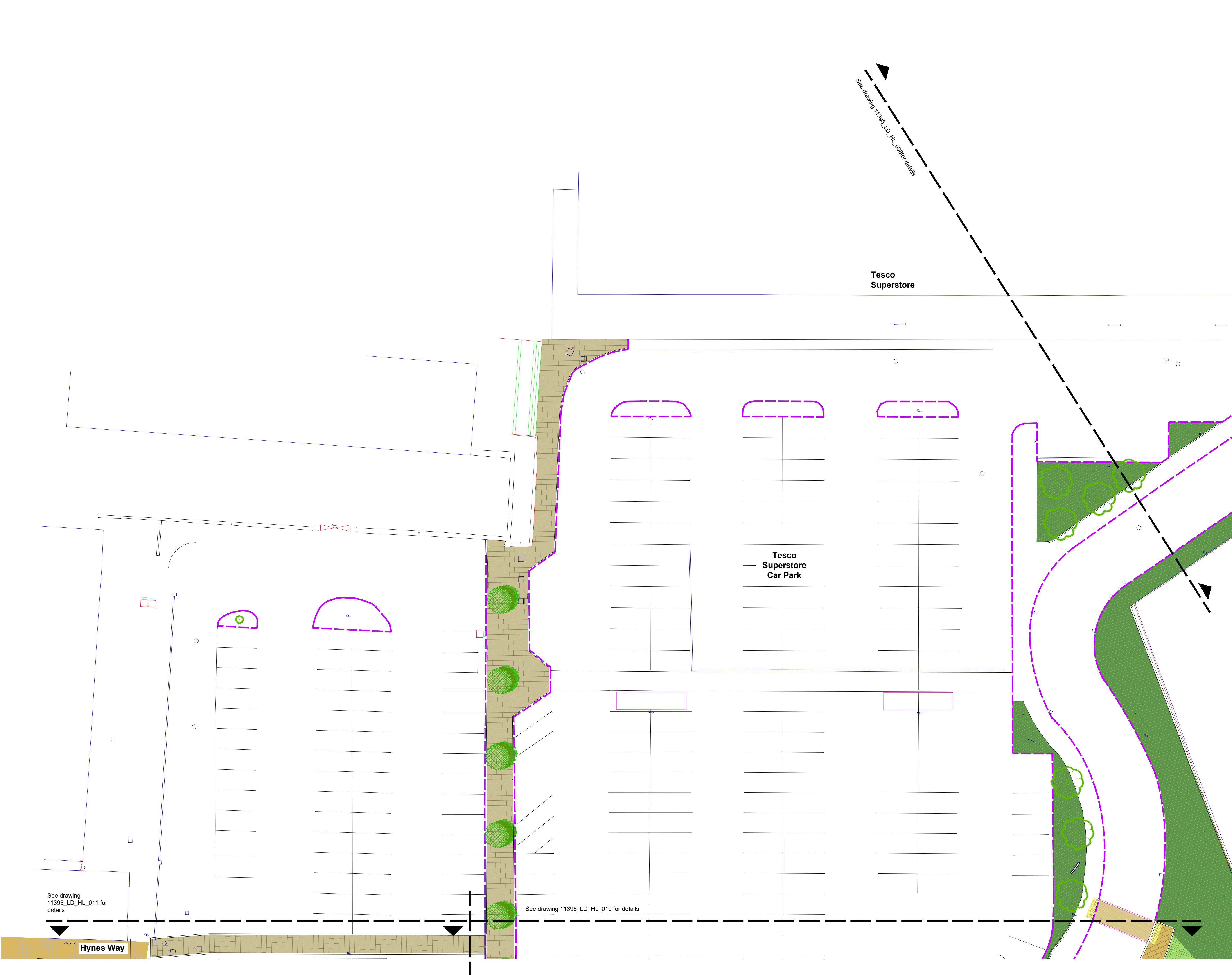

Notes
Do not scale from this drawing.
All dimensions are drawn in millimetres.
Drawing & design copyright LUC.
Reproduction of this drawing in whole or in part is prohibited without prior permission.

- Proposed upstanding Kerb
- Proposed flush kerb
- Asphalt surfacing
- Natural stone paving
- Concrete paving
- Natural stone sett paving
- Cycleway surfacing
- Cycleway sett surfacing
- Insitu concrete surfacing
- Concrete sett surfacing
- Concrete plank surfacing with exposed aggregate surfacing
- Poured concrete surfacing
- Existing sett surfacing retained
- Proposed tactile paving
- Existing Lighting Column Location
- Proposed ornamental planting
- Proposed hedge planting
- Grass verge surfacing
- Proposed tree planting
- Existing tree planting retained
- Existing planting retained
- Existing grass retained
- Existing kerbline retained

Iss	Date	Description	Drn	Chk

LUC

LUC Manchester
6th Floor, 55 King Street, Manchester, M2 4LQ
+44 (0)161 537 5960
manchester@landuse.co.uk
www.landuse.co.uk

Project Roscommon Public Realm Enhancement & Cycleways Projects		
Client Roscommon County Council		
Scale @A1 1:200	Status For Planning	
Drawing Title Public Realm Proposals General Arrangement (Sheet 9 of 16)		
Job Nr 11395	Drawing Nr 11395_LD_HL_009	Issue



See drawing 11395_LD_HL_009 for details

Roscommon
Co-Operative
Livestock Mart

Toy
Town

One-way

One-way

Iceland

See drawing
11395_LD_HL_002
for details

See drawing
11395_LD_HL_011
for details

Notes
Do not scale from this drawing.
All dimensions are drawn in millimetres.
Drawing & design copyright LUC.
Reproduction of this drawing in whole or in part is prohibited without
prior permission.

- Proposed upstanding Kerb
- Proposed flush kerb
- Asphalt surfacing
- Natural stone paving
- Concrete paving
- Natural stone sett paving
- Cycleway surfacing
- Cycleway sett surfacing
- Insitu concrete surfacing
- Concrete sett surfacing
- Concrete plank surfacing with exposed aggregate surfacing
- Poured concrete surfacing
- Existing sett surfacing retained
- Proposed tactile paving
- Existing Lighting Column Location
- Proposed ornamental planting
- Proposed hedge planting
- Grass verge surfacing
- Proposed tree planting
- Existing tree planting retained
- Existing planting retained
- Existing grass retained
- Existing kerbline retained

Iss	Date	Description	Dwn	Chk

LUC

LUC Manchester
6th Floor, 55 King Street, Manchester, M2 4LQ
+44 (0)161 537 5960
manchester@landuse.co.uk
www.landuse.co.uk

Project
Roscommon Public Realm Enhancement &
Cycleways Projects

Client
Roscommon County Council

Scale @A1
1:200

Status
For Planning

Drawing Title
Public Realm Proposals General Arrangement
(Sheet 10 of 16)

Job Nr
11395

Drawing Nr
11395_LD_HL_010

Issue

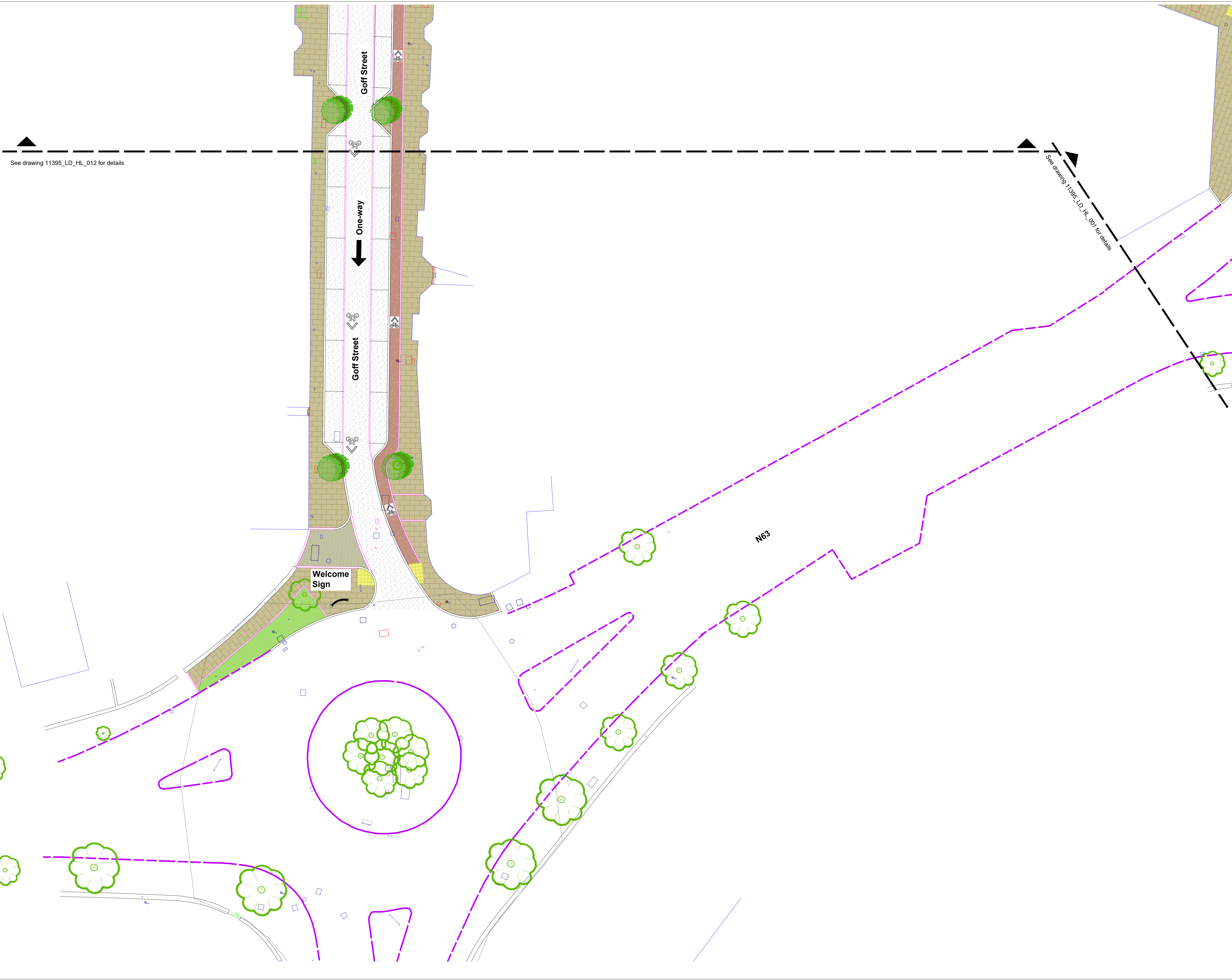

See drawing 11395_LD_HL_012 for details

See drawing 11395_LD_HL_001 for details

Notes
Do not scale from this drawing.
All dimensions are drawn in millimetres.
Drawing & design copyright LUC.
Reproduction of this drawing in whole or in part is prohibited without prior permission.

- Proposed upstanding Kerb
- Proposed flush kerb
- Asphalt surfacing
- Natural stone paving
- Concrete paving
- Natural stone sett paving
- Cycleway surfacing
- Cycleway sett surfacing
- Insitu concrete surfacing
- Concrete sett surfacing
- Concrete plank surfacing with exposed aggregate surfacing
- Poured concrete surfacing
- Existing sett surfacing retained
- Proposed tactile paving
- Existing Lighting Column Location
- Proposed ornamental planting
- Proposed hedge planting
- Grass verge surfacing
- Proposed tree planting
- Existing tree planting retained
- Existing planting retained
- Existing grass retained
- Existing kerbline retained

Iss	Date	Description	Drn	Chk

LUC

LUC Manchester
6th Floor, 55 King Street, Manchester, M2 4LQ
+44 (0)161 537 5960
manchester@landuse.co.uk
www.landuse.co.uk

Project
Roscommon Public Realm Enhancement & Cycleways Projects

Client
Roscommon County Council

Scale @A1 1:200	Status For Planning
--------------------	------------------------

Drawing Title
Public Realm Proposals General Arrangement
(Sheet 12 of 16)

Job Nr 11395	Drawing Nr 11395_LD_HL_012	Issue
-----------------	-------------------------------	-------



See drawing
11395_LD_HL_011
for details

Notes
Do not scale from this drawing.
All dimensions are drawn in millimetres.
Drawing & design copyright LUC.
Reproduction of this drawing in whole or in part is prohibited without prior permission.

- Proposed flush kerb
- Asphalt surfacing
- Natural stone paving
- Concrete paving
- Natural stone sett paving
- Cycleway surfacing
- Cycleway sett surfacing
- Insitu concrete surfacing
- Concrete sett surfacing
- Concrete plank surfacing with exposed aggregate surfacing
- Poured concrete surfacing
- Existing sett surfacing retained
- Proposed tactile paving
- Existing Lighting Column Location
- Proposed ornamental planting
- Proposed hedge planting
- Grass verge surfacing
- Proposed tree planting
- Existing tree planting retained
- Existing planting retained
- Existing grass retained
- Existing kerbline retained

Iss	Date	Description		Drn	Chk

LUC

LUC Manchester
6th Floor, 55 King Street, Manchester, M2 4LQ
+44 (0)161 537 5960
manchester@landuse.co.uk
www.landuse.co.uk

Project Roscommon Public Realm Enhancement & Cycleways Projects	
Client Roscommon County Council	
Scale @A1 1:200	Status For Planning
Drawing Title Public Realm Proposals General Arrangement (Sheet 14 of 16)	

Job Nr 11395	Drawing Nr 11395_LD_HL_014	Issue
-----------------	-------------------------------	-------



See viewpoint below for remaining section of Henry Street

See drawing 11395_LD_HL_0014 for details

Notes
Do not scale from this drawing.
All dimensions are drawn in millimetres.
Drawing & design copyright LUC.
Reproduction of this drawing in whole or in part is prohibited without prior permission.

- Proposed upstanding Kerb
- Proposed flush kerb
- Asphalt surfacing
- Natural stone paving
- Concrete paving
- Natural stone sett paving
- Cycleway surfacing
- Cycleway sett surfacing
- Insitu concrete surfacing
- Concrete sett surfacing
- Concrete plank surfacing with exposed aggregate surfacing
- Poured concrete surfacing
- Existing sett surfacing retained
- Proposed tactile paving
- Existing Lighting Column Location
- Proposed ornamental planting
- Proposed hedge planting
- Grass verge surfacing
- Proposed tree planting
- Existing tree planting retained
- Existing planting retained
- Existing grass retained
- Existing kerbline retained

Iss	Date	Description	Drn	Chk

LUC

LUC Manchester
6th Floor, 55 King Street, Manchester, M2 4LQ
+44 (0)161 537 5960
manchester@landuse.co.uk
www.landuse.co.uk

Project
Roscommon Public Realm Enhancement & Cycleways Projects

Client
Roscommon County Council

Scale @A1
1:200

Status
For Planning

Drawing Title
Public Realm Proposals General Arrangement (Sheet 15 of 16)

Job Nr 11395	Drawing Nr 11395_LD_HL_015	Issue
-----------------	-------------------------------	-------



Notes
Do not scale from this drawing.
All dimensions are drawn in millimetres.
Drawing & design copyright LUC.
Reproduction of this drawing in whole or in part is prohibited without prior permission.

- Proposed upstanding Kerb
- Proposed flush kerb
- Asphalt surfacing
- Natural stone paving
- Concrete paving
- Natural stone sett paving
- Cycleway surfacing
- Cycleway sett surfacing
- Insitu concrete surfacing
- Concrete sett surfacing
- Concrete plank surfacing with exposed aggregate surfacing
- Poured concrete surfacing
- Existing sett surfacing retained
- Proposed tactile paving
- Existing Lighting Column Location
- Proposed ornamental planting
- Proposed hedge planting
- Grass verge surfacing
- Proposed tree planting
- Existing tree planting retained
- Existing planting retained
- Existing grass retained
- Existing kerbline retained

Iss	Date	Description	Drn	Chk

LUC Manchester
6th Floor, 55 King Street, Manchester, M2 4LQ
+44 (0)161 537 5960
manchester@landuse.co.uk
www.landuse.co.uk

Project Roscommon Public Realm Enhancement & Cycleways Projects	
Client Roscommon County Council	
Scale @A1 1:200	Status For Planning
Drawing Title Public Realm Proposals General Arrangement (Sheet 14 of 16)	
Job Nr 11395	Drawing Nr 11395_LD_HL_016
Issue	